

**KEY / LEGEND**

- EXISTING - EV PARKING BAY
- OPT 1 - EV PROPOSED BAY
- NEW TRAFFIC ISLAND WITH CHARGE POINT
- EV FEDDER PILLAR
- EXISTING SOURCE LONDON CP
- BT DUCTING
- ELEC DUCTING
- BT STATUTORY PLANT
- EXISTING LAMP COLUMN
- CP EXCLUSION ZONE (2.5m Radius)
- REMOVAL
- SETTING OUT POINT

EASTINGS	533181
NORTHINGS	188859
POSTCODE	N15 5JB

**LOCATION PLAN**

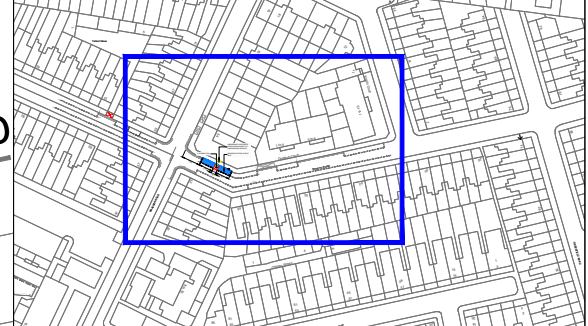

Rev.	Date	Comments	Des	Chk	App
-		ORIGINAL ISSUE			

**its** intelligent transport services

t +44 (0)20 3318 8560

**source**  
LONDON

e sales@its-global.co.uk

Client :  
**LB Haringey**

Title:  
**GENERAL LAYOUT**  
TMO Drawing - EV Layouts  
Roslyn Road

Drawing No. 58/1030/TMO/047	Sheet No. 1 OF 1	Rev. -
--------------------------------	---------------------	-----------

1:200 @ A3

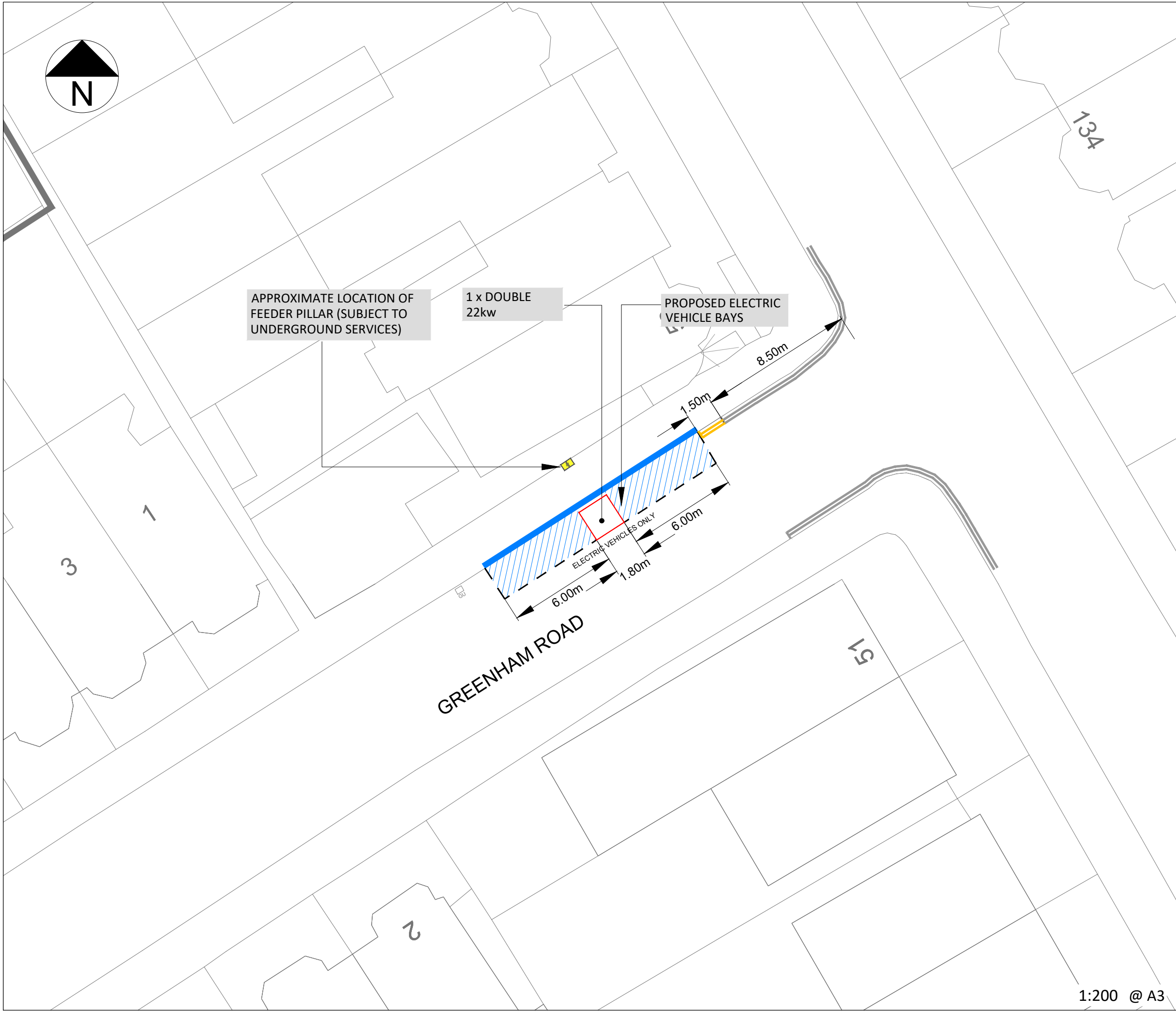

**KEY / LEGEND**

- EXISTING - EV PARKING BAY
- OPT 1 - EV PROPOSED BAY
- NEW TRAFFIC ISLAND WITH CHARGE POINT
- EV FEDDER PILLAR
- EXISTING SOURCE LONDON CP
- BT DUCTING
- ELEC DUCTING
- BT STATUTORY PLANT
- EXISTING LAMP COLUMN
- CP EXCLUSION ZONE (2.5m Radius)
- REMOVAL
- SETTING OUT POINT

EASTINGS	528447
NORTHINGS	190506
POSTCODE	N10 1LP

**LOCATION PLAN**

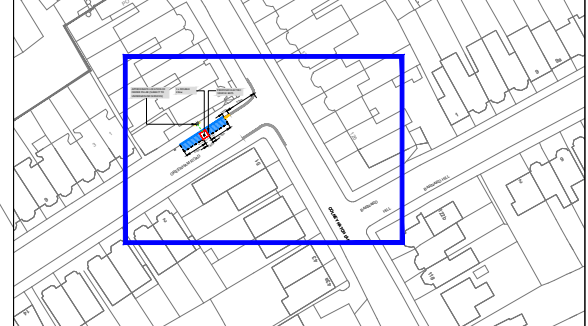

Rev.	Date	Comments	Des	Chk	App
-		ORIGINAL ISSUE			

Intelligent transport services

t +44 (0)20 3318 8560

source LONDON

e sales@its-global.co.uk

Client :  
**LB Haringey**

Title:  
**GENERAL LAYOUT**  
TMO Drawing - EV Layouts  
Greenham Road

Drawing No. 58/1030/TMO/067	Sheet No. 1 OF 1	Rev. -
--------------------------------	---------------------	-----------

1:200 @ A3

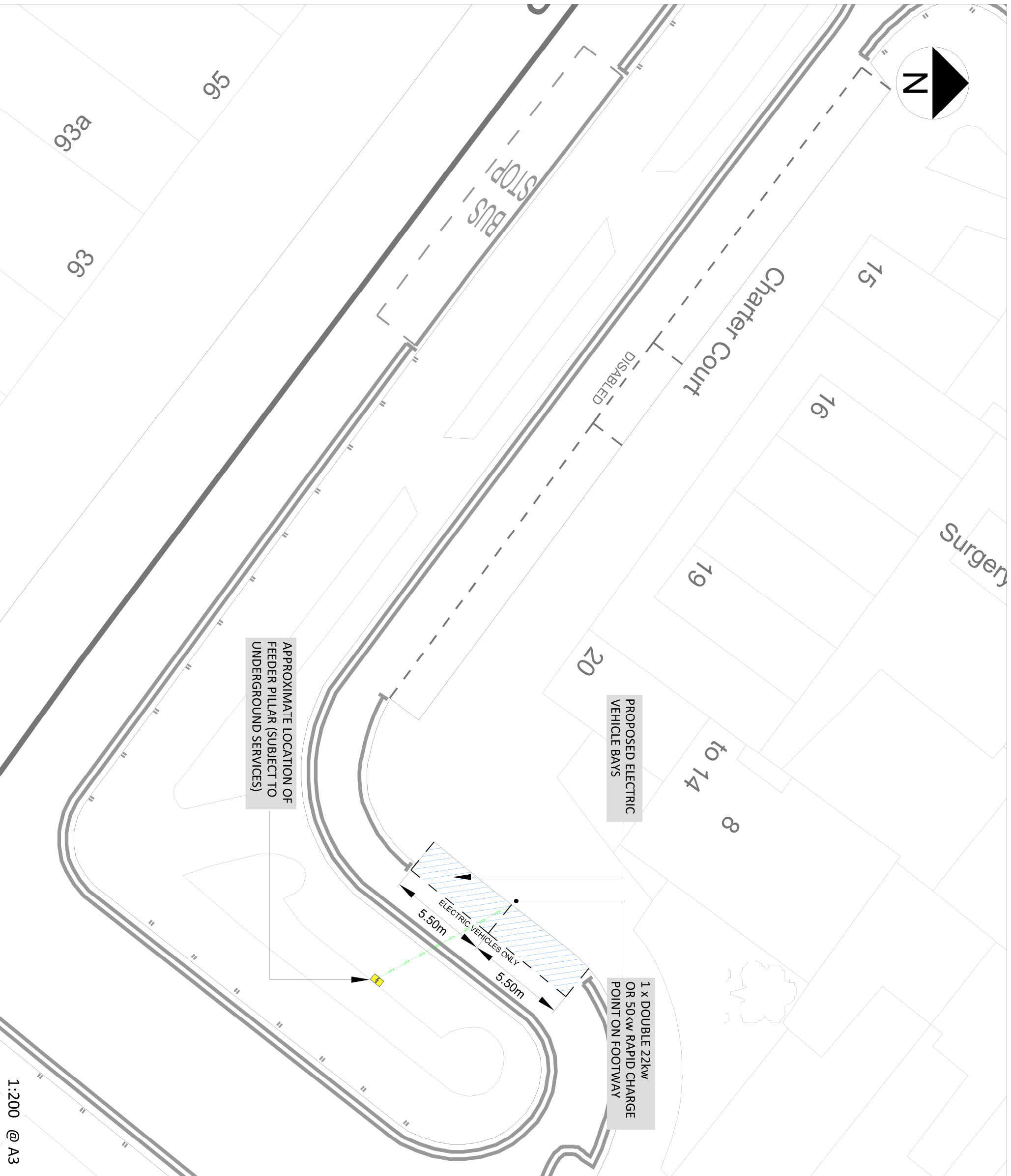

**KEY / LEGEND**

- EXISTING - EV PARKING BAY
- OPT 1 - EV PROPOSED BAY
- NEW TRAFFIC ISLAND WITH CHARGE POINT
- EV FEEDER PILLAR
- EXISTING SOURCE LONDON CP
- BT DUCTING
- ELEC DUCTING
- BT STATUTORY PLANT
- EXISTING LAMP COLUMN
- CP EXCLUSION ZONE (2.5m Radius) REMOVAL
- SETTING OUT POINT

EASTINGS 531044  
 NORTHINGS 187250  
 POSTCODE N4 3SG  
**LOCATION PLAN**

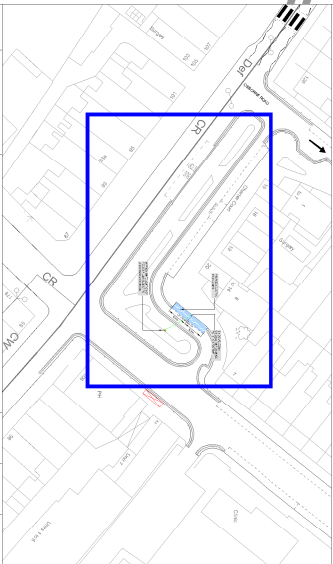

Rev. Date	Comments	Des	Chk	App
-	ORIGINAL ISSUE			



Client: **LB Haringey**  
 t +44 (0)20 3318 8560 e sales@its-global.co.uk

Title:  
**GENERAL LAYOUT**  
 TMO Drawing - EV Layouts  
 Osborne Road

1:200 @ A3

Drawing No. 58/1030/TMO/078	Sheet No. 1 OF 1	Rev. -
--------------------------------	---------------------	-----------



### KEY / LEGEND

- EXISTING - EV PARKING BAY
- OPT 1 - EV PROPOSED BAY
- NEW TRAFFIC ISLAND WITH CHARGE POINT
- EV FEDDER PILLAR
- EXISTING SOURCE LONDON CP
- BT DUCTING
- ELEC DUCTING
- BT STATUTORY PLANT
- EXISTING LAMP COLUMN
- CP EXCLUSION ZONE (2.5m Radius)
- REMOVAL
- SETTING OUT POINT

EASTINGS	531393
NORTHINGS	188532
POSTCODE	N4 1DL

### LOCATION PLAN

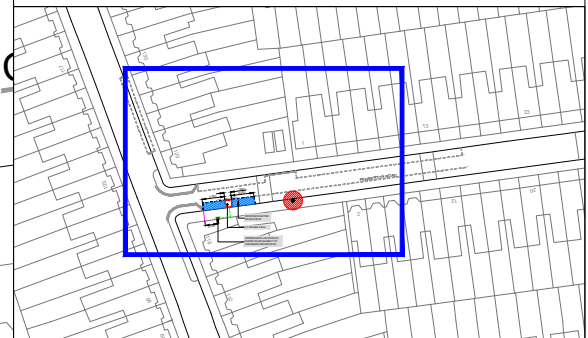

Rev.	Date	Comments	Des	Chk	App
-		ORIGINAL ISSUE			

**its**  
intelligent  
transport  
services

t +44 (0)20 3318 8560

**source**  
LONDON

e sales@its-global.co.uk

Client :  
**LB Haringey**

Title:  
**GENERAL LAYOUT**  
TMO Drawing - EV Layouts  
Pemberton Road

Drawing No. 58/1030/TMO/083	Sheet No. 1 OF 1	Rev. -
--------------------------------	---------------------	-----------

1:200 @ A3

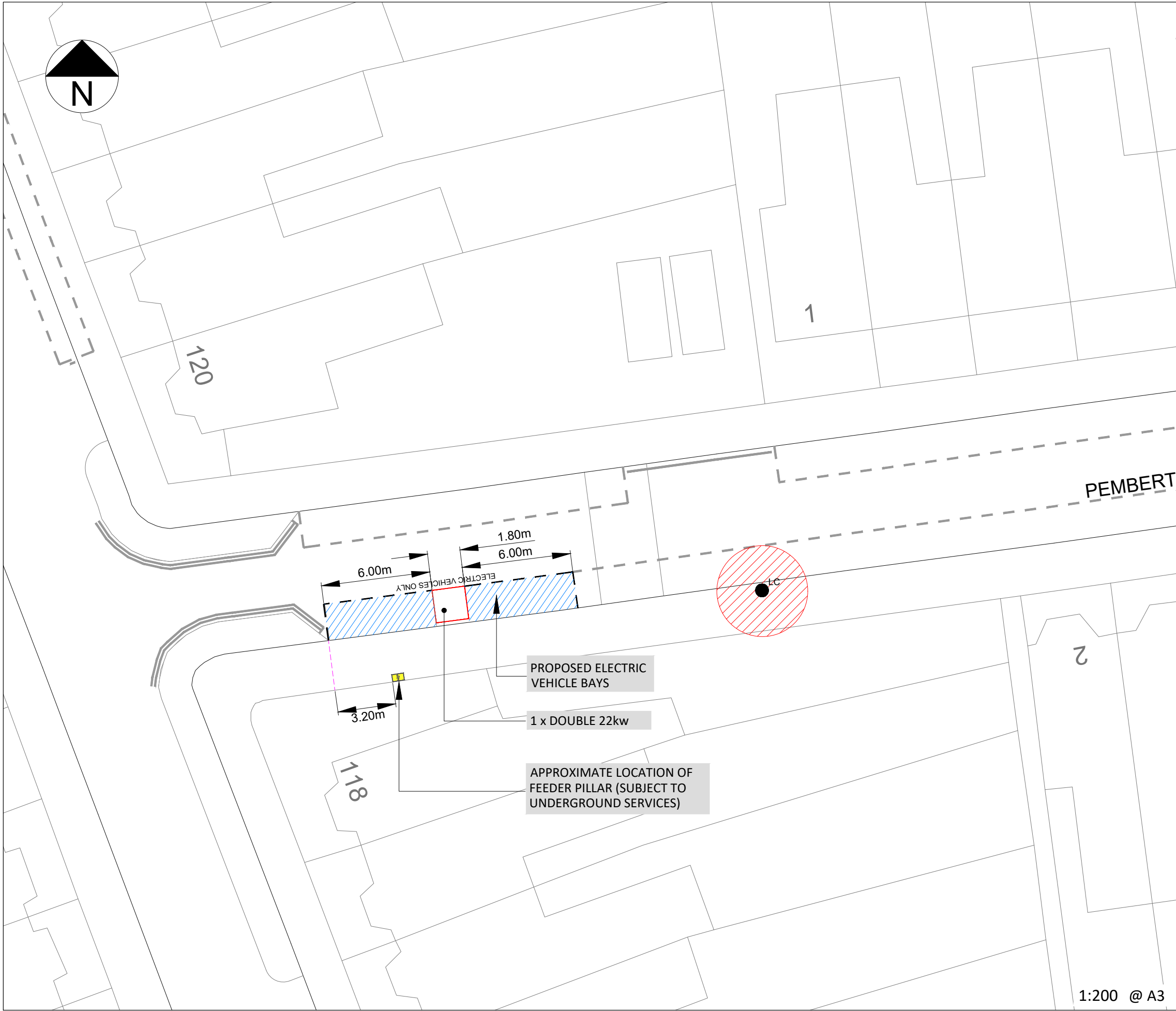

BASED UPON ORDNANCE SURVEY'S MAPS WITH THE PERMISSION OF THE CONTROLLER OF HMSO. (c) CROWN COPYRIGHT. UNAUTHORISED REPRODUCTION INFRINGES CROWN COPYRIGHT AND MAY LEAD TO PROSECUTION OR CIVIL PROCEEDINGS. XXX

CAD REFERENCE: G:\Shared drives\58-Bollore-Total\58-1030-BPL-LB Haringey\Master Filing System\02-Location Drawings\03-TMO Drawings\58-1030-083-TMO-Pemberton Road - 58-1030-TMO-083 DATE: 01/11/2023



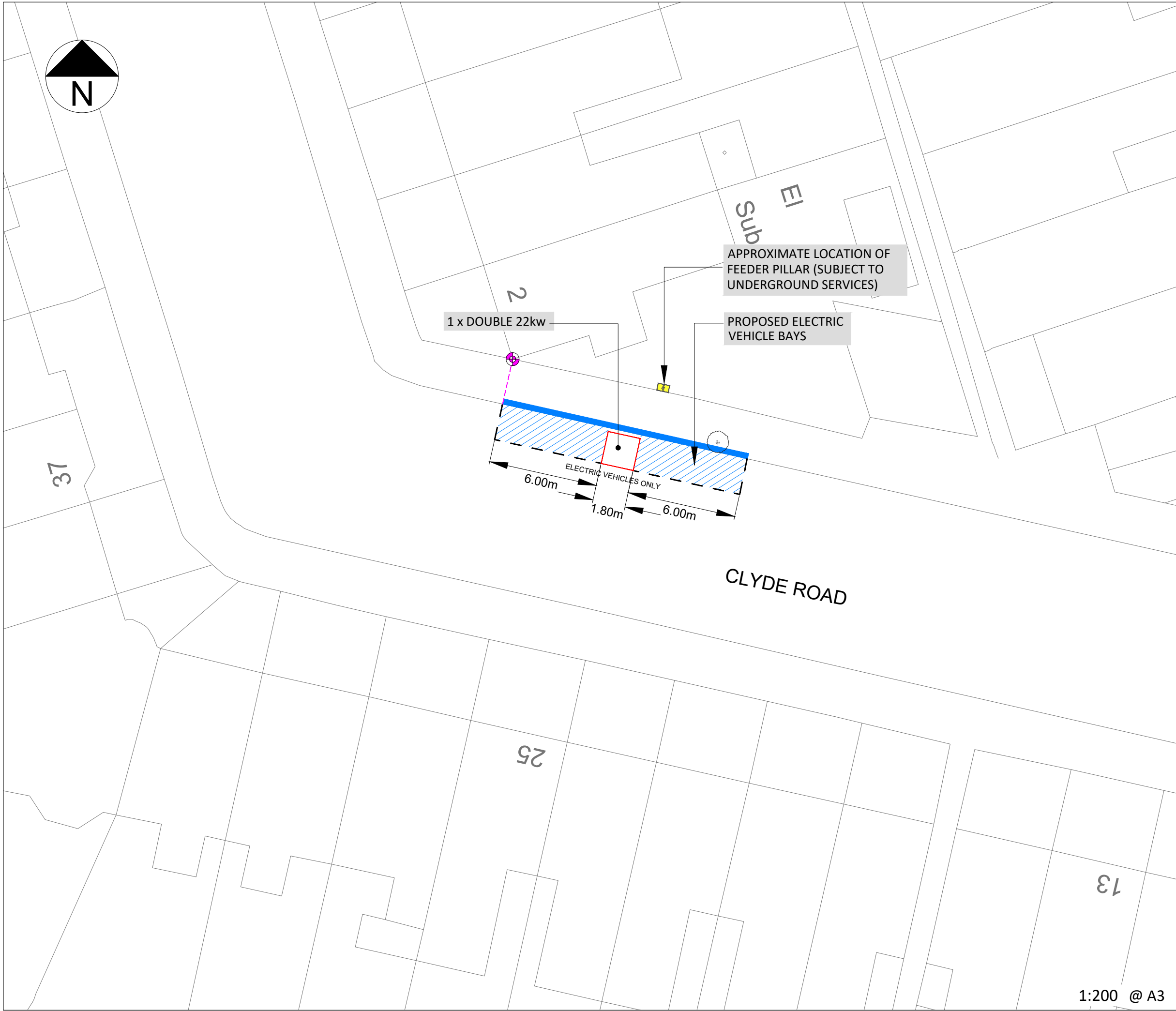
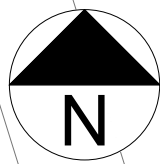

**KEY / LEGEND**

- EXISTING - EV PARKING BAY
- OPT 1 - EV PROPOSED BAY
- NEW TRAFFIC ISLAND WITH CHARGE POINT
- EV FEDDER PILLAR
- EXISTING SOURCE LONDON CP
- BT DUCTING
- ELEC DUCTING
- BT STATUTORY PLANT
- EXISTING LAMP COLUMN
- CP EXCLUSION ZONE (2.5m Radius)
- REMOVAL
- SETTING OUT POINT

EASTINGS	529703
NORTHINGS	190664
POSTCODE	N22 7AG

**LOCATION PLAN**

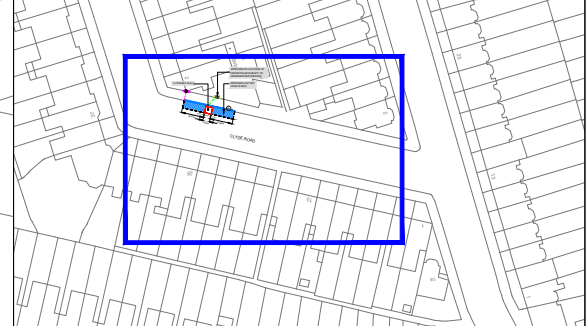

Rev.	Date	Comments	Des	Chk	App
-		ORIGINAL ISSUE			

Intelligent transport services

t +44 (0)20 3318 8560

source LONDON

e sales@its-global.co.uk

Client :  
**LB Haringey**

Title:  
**GENERAL LAYOUT**  
TMO Drawing - EV Layouts  
Clyde Road

Drawing No. 58/1030/TMO/085	Sheet No. 1 OF 1	Rev. -
--------------------------------	---------------------	-----------

1:200 @ A3

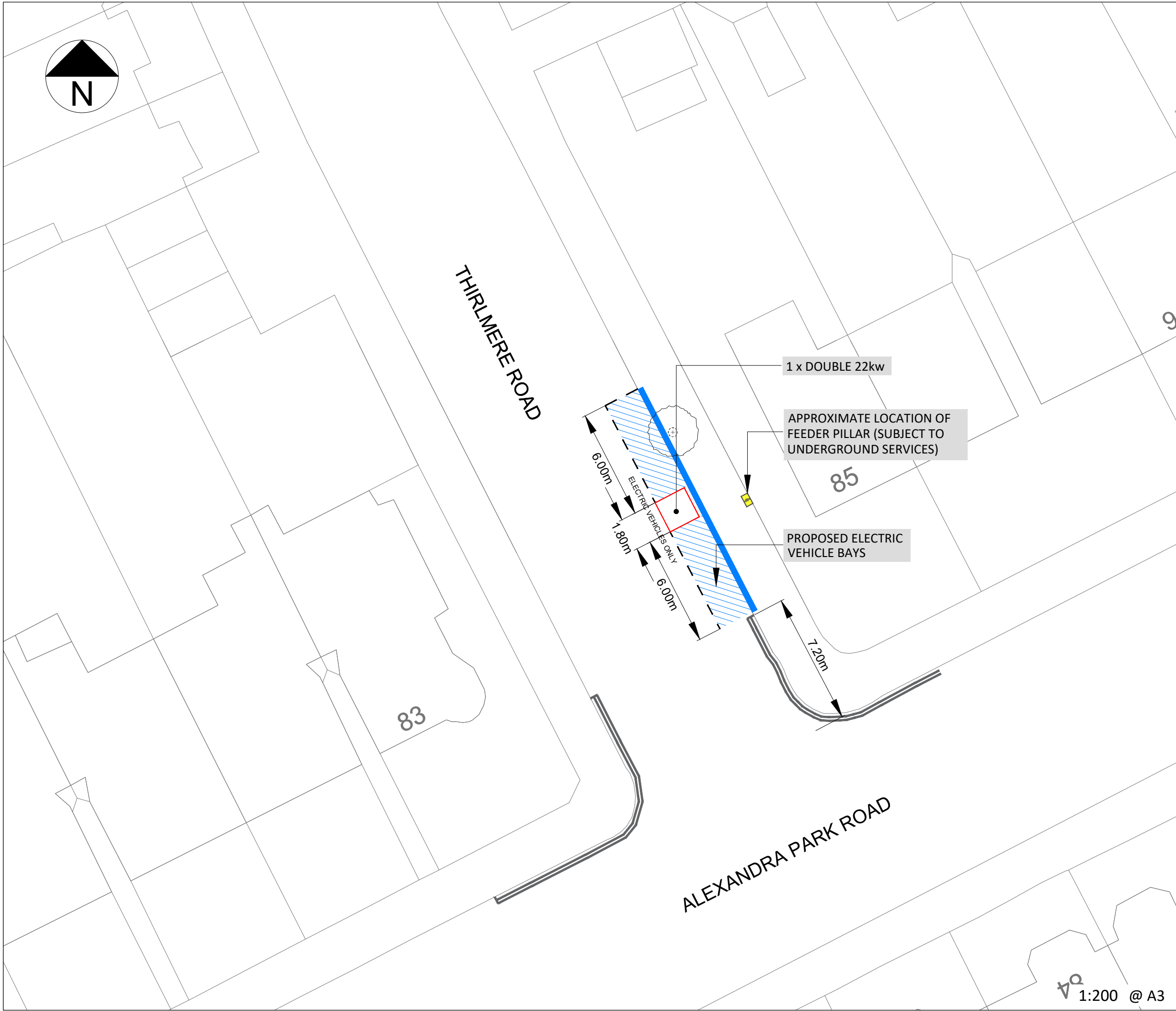
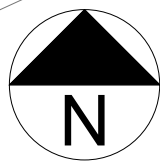

**KEY / LEGEND**

- EXISTING - EV PARKING BAY
- OPT 1 - EV PROPOSED BAY
- NEW TRAFFIC ISLAND WITH CHARGE POINT
- EV FEDDER PILLAR
- EXISTING SOURCE LONDON CP
- BT DUCTING
- ELEC DUCTING
- BT STATUTORY PLANT
- EXISTING LAMP COLUMN
- CP EXCLUSION ZONE (2.5m Radius)
- REMOVAL
- SETTING OUT POINT

EASTINGS	528949
NORTHINGS	190481
POSTCODE	N10 1DY

**LOCATION PLAN**

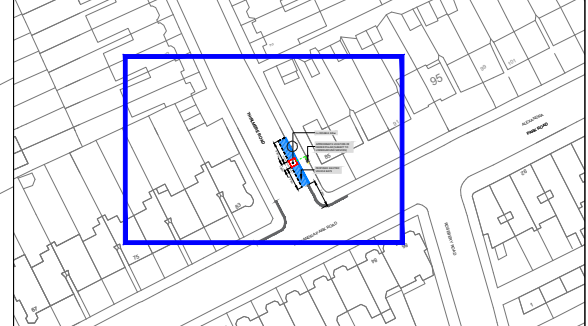

Rev.	Date	Comments	Des	Chk	App
-		ORIGINAL ISSUE			

intelligent transport services

t +44 (0)20 3318 8560

e sales@its-global.co.uk

Client :  
**LB Haringey**







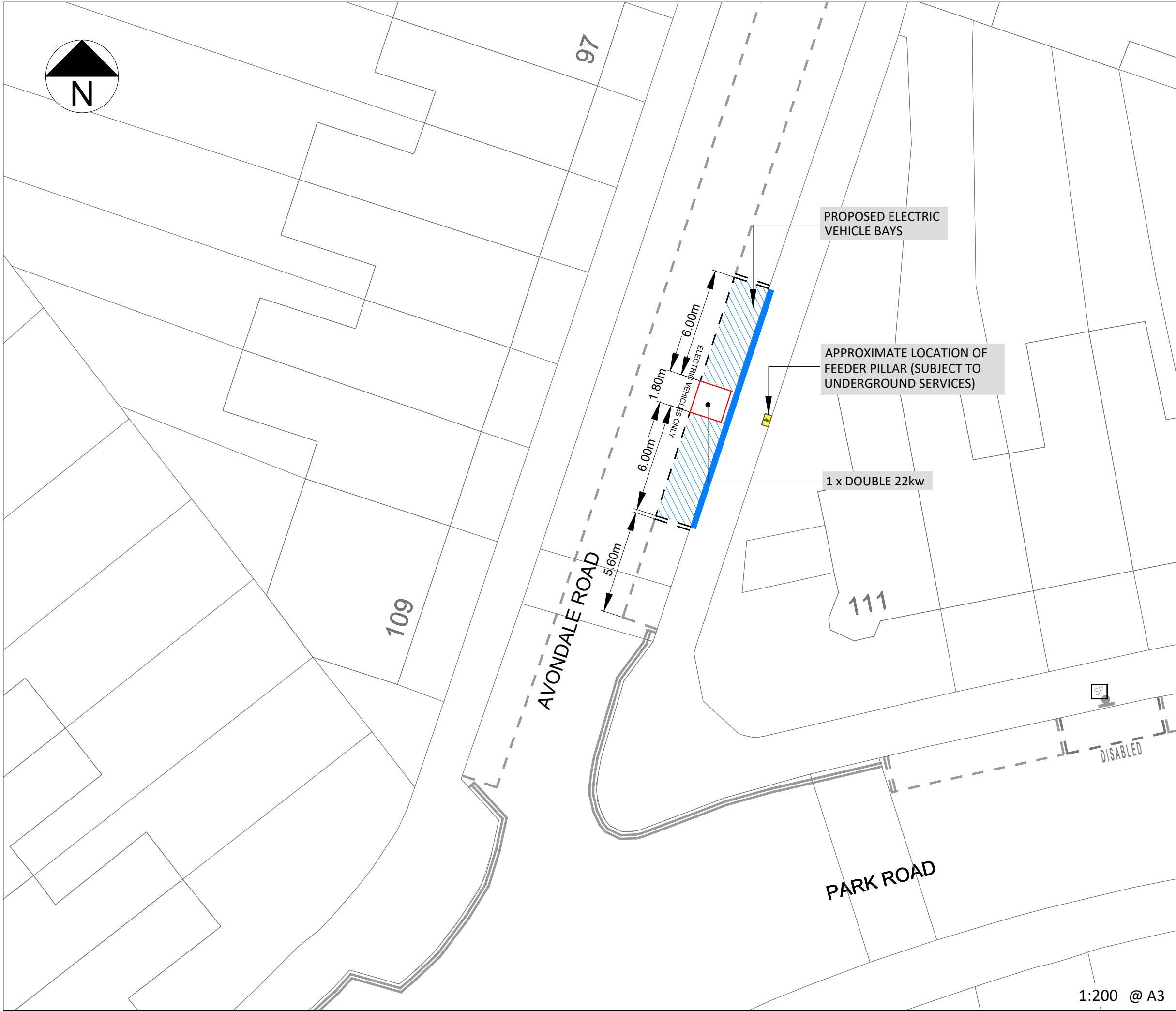
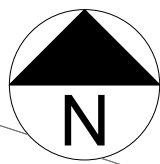





Title:  
**GENERAL LAYOUT**  
TMO Drawing - EV Layouts  
Thirlmere Road

Drawing No. 58/1030/TMO/101	Sheet No. 1 OF 1	Rev. -
--------------------------------	---------------------	-----------

1:200 @ A3



**KEY / LEGEND**

- EXISTING - EV PARKING BAY 
- OPT 1 - EV PROPOSED BAY 
- NEW TRAFFIC ISLAND WITH CHARGE POINT 
- EV FEDDER PILLAR 
- EXISTING SOURCE LONDON CP 
- BT DUCTING 
- ELEC DUCTING 
- BT STATUTORY PLANT 
- EXISTING LAMP COLUMN 
- CP EXCLUSION ZONE (2.5m Radius) 
- REMOVAL 
- SETTING OUT POINT 

EASTINGS	531949
NORTHINGS	188766
POSTCODE	N15 3SH

**LOCATION PLAN**

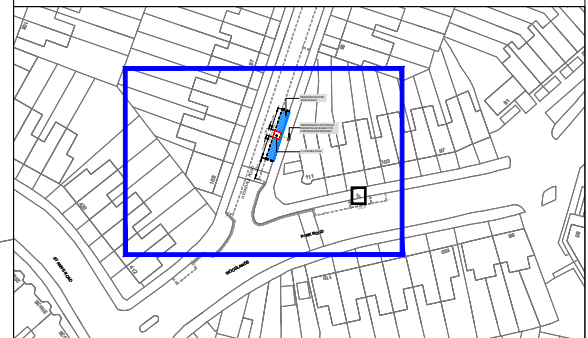

Rev.	Date	Comments	Des	Chk	App
-		ORIGINAL ISSUE			



Intelligent transport services

t +44 (0)20 3318 8560



source LONDON

e sales@its-global.co.uk

Client :  
**LB Haringey**

Title:  
**GENERAL LAYOUT**  
TMO Drawing - EV Layouts  
Avondale Road

Drawing No. 58/1030/TMO/159	Sheet No. 1 OF 1	Rev. -
--------------------------------	---------------------	-----------

1:200 @ A3

# Area 6 Centre

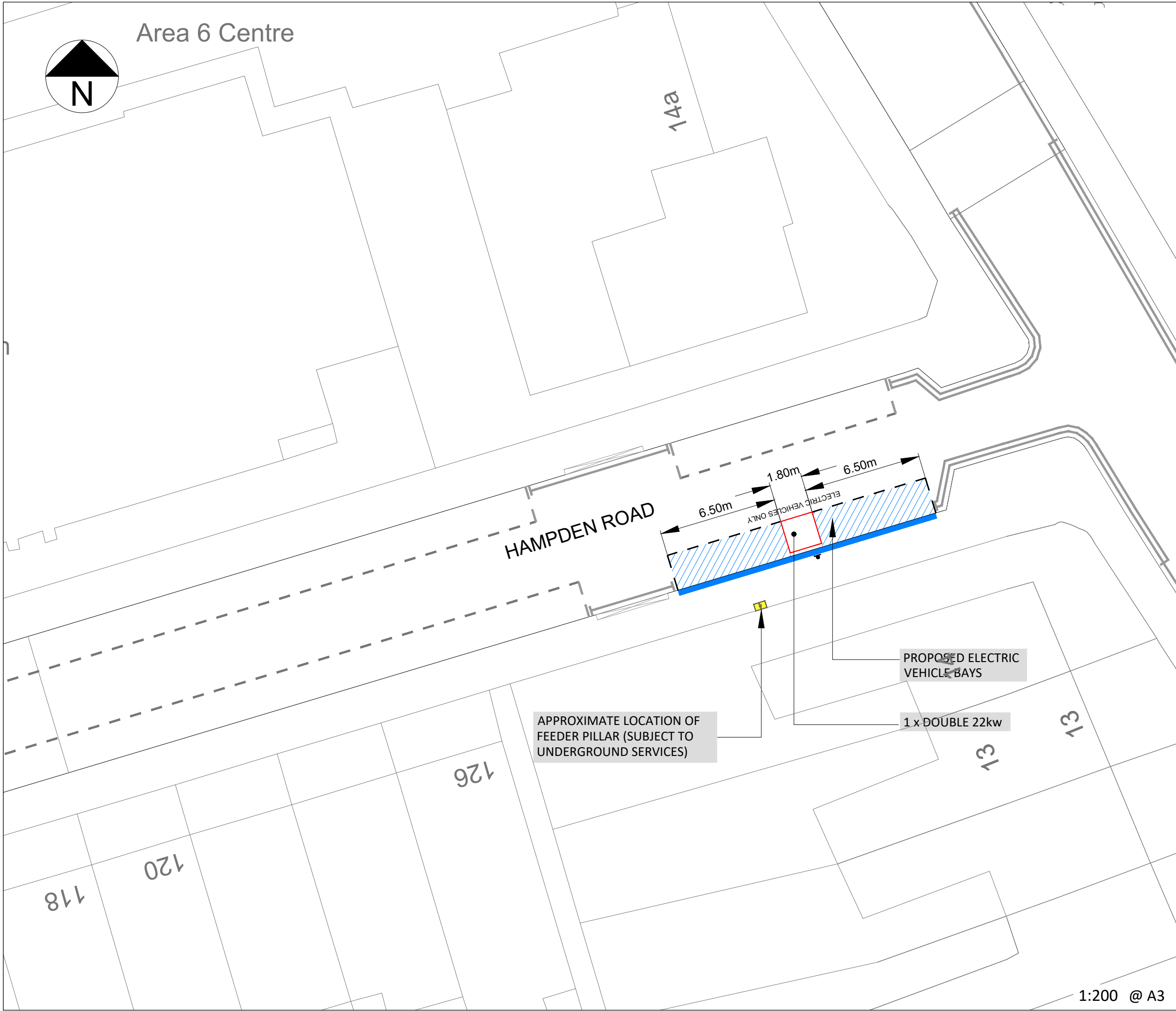
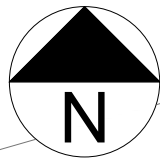

## KEY / LEGEND

- EXISTING - EV PARKING BAY
- OPT 1 - EV PROPOSED BAY
- NEW TRAFFIC ISLAND WITH CHARGE POINT
- EV FEDDER PILLAR
- EXISTING SOURCE LONDON CP
- BT DUCTING
- ELEC DUCTING
- BT STATUTORY PLANT
- EXISTING LAMP COLUMN
- CP EXCLUSION ZONE (2.5m Radius)
- REMOVAL
- SETTING OUT POINT

EASTINGS	531496
NORTHINGS	189394
POSTCODE	N8 0HS

## LOCATION PLAN

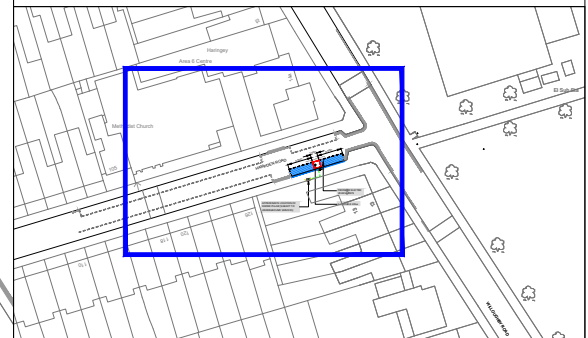

Rev.	Date	Comments	Des	Chk	App
-		ORIGINAL ISSUE			

APPROXIMATE LOCATION OF FEEDER PILLAR (SUBJECT TO UNDERGROUND SERVICES)

PROPOSED ELECTRIC VEHICLE BAYS

1 x DOUBLE 22kw

1:200 @ A3

Intelligent transport services

t +44 (0)20 3318 8560

source LONDON

e sales@its-global.co.uk

Client :  
**LB Haringey**

Title:  
**GENERAL LAYOUT**  
TMO Drawing - EV Layouts  
Hampden Road

Drawing No. 58/1030/TMO/161	Sheet No. 1 OF 1	Rev. -
--------------------------------	---------------------	-----------



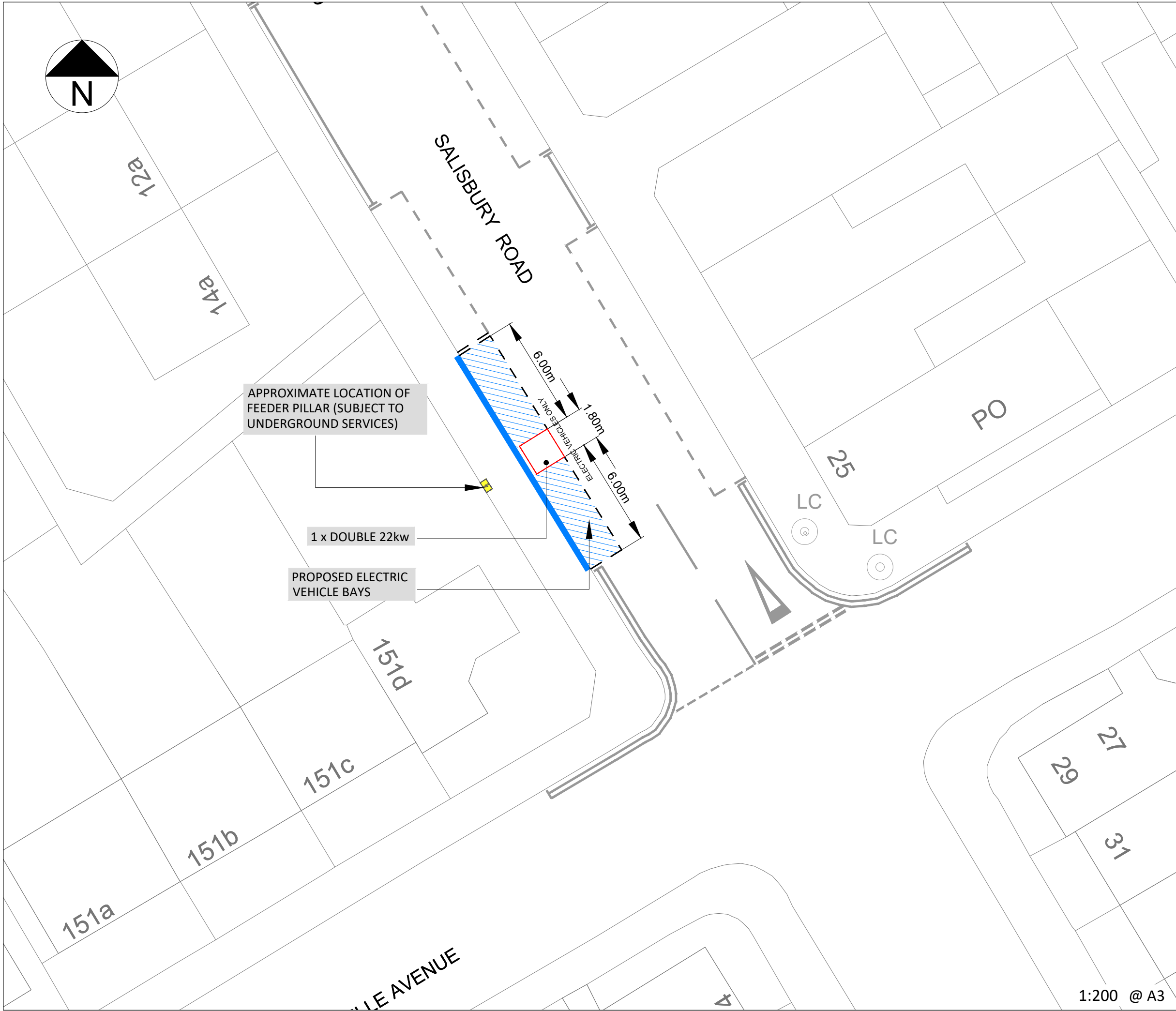
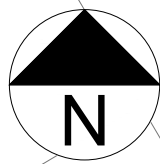

APPROXIMATE LOCATION OF FEEDER PILLAR (SUBJECT TO UNDERGROUND SERVICES)

1 x DOUBLE 22kw

PROPOSED ELECTRIC VEHICLE BAYS

**KEY / LEGEND**

- EXISTING - EV PARKING BAY
- OPT 1 - EV PROPOSED BAY
- NEW TRAFFIC ISLAND WITH CHARGE POINT
- EV FEDDER PILLAR
- EXISTING SOURCE LONDON CP
- BT DUCTING
- ELEC DUCTING
- BT STATUTORY PLANT
- EXISTING LAMP COLUMN
- CP EXCLUSION ZONE (2.5m Radius)
- REMOVAL
- SETTING OUT POINT

EASTINGS	531532
NORTHINGS	190512
POSTCODE	N22 6NN

**LOCATION PLAN**

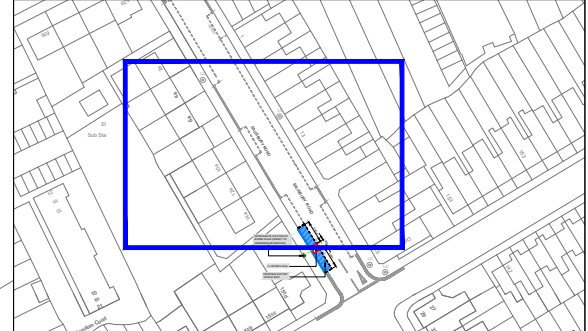

Rev.	Date	Comments	Des	Chk	App
-		ORIGINAL ISSUE			



t +44 (0)20 3318 8560 e sales@its-global.co.uk

Client :  
**LB Haringey**

Title:  
**GENERAL LAYOUT**  
TMO Drawing - EV Layouts  
Salisbury Road

Drawing No. 58/1030/TMO/163	Sheet No. 1 OF 1	Rev. -
--------------------------------	---------------------	-----------

1:200 @ A3

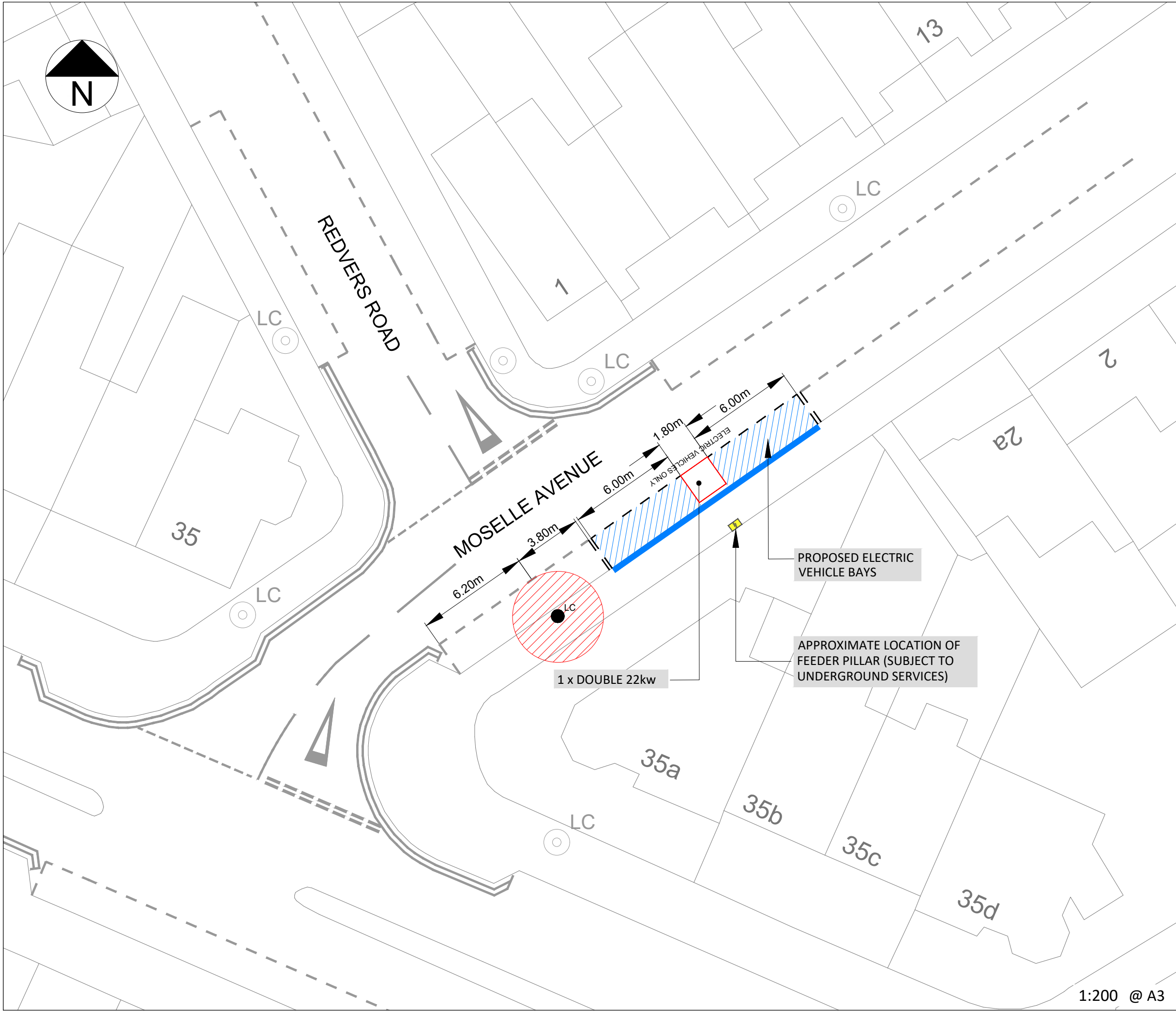

KEY / LEGEND	
EXISTING - EV PARKING BAY	
OPT 1 - EV PROPOSED BAY	
NEW TRAFFIC ISLAND WITH CHARGE POINT	
EV FEDDER PILLAR	
EXISTING SOURCE LONDON CP	
BT DUCTING	
ELEC DUCTING	
BT STATUTORY PLANT	
EXISTING LAMP COLUMN	
CP EXCLUSION ZONE (2.5m Radius)	
REMOVAL	
SETTING OUT POINT	

EASTINGS	531201
NORTHINGS	190269
POSTCODE	N22 6NE

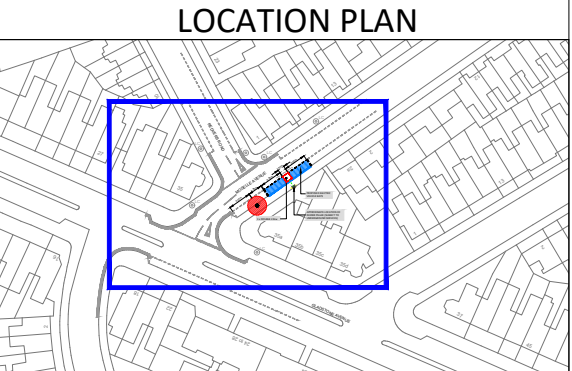

Rev.	Date	Comments	Des	Chk	App
-		ORIGINAL ISSUE			

its  
intelligent  
transport  
services

t +44 (0)20 3318 8560

source  
LONDON

e sales@its-global.co.uk

Client :  
**LB Haringey**

Title:  
**GENERAL LAYOUT**  
TMO Drawing - EV Layouts  
Moselle Avenue

Drawing No. 58/1030/TMO/165	Sheet No. 1 OF 1	Rev. -
--------------------------------	---------------------	-----------

1:200 @ A3

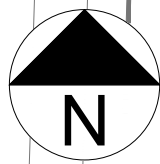

**KEY / LEGEND**

EXISTING - EV PARKING BAY	
OPT 1 - EV PROPOSED BAY	
NEW TRAFFIC ISLAND WITH CHARGE POINT	
EV FEDDER PILLAR	
EXISTING SOURCE LONDON CP	
BT DUCTING	
ELEC DUCTING	
BT STATUTORY PLANT	
EXISTING LAMP COLUMN	
CP EXCLUSION ZONE (2.5m Radius)	
REMOVAL	
SETTING OUT POINT	

EASTINGS	531436
NORTHINGS	187816
POSTCODE	N4 1EF

**LOCATION PLAN**

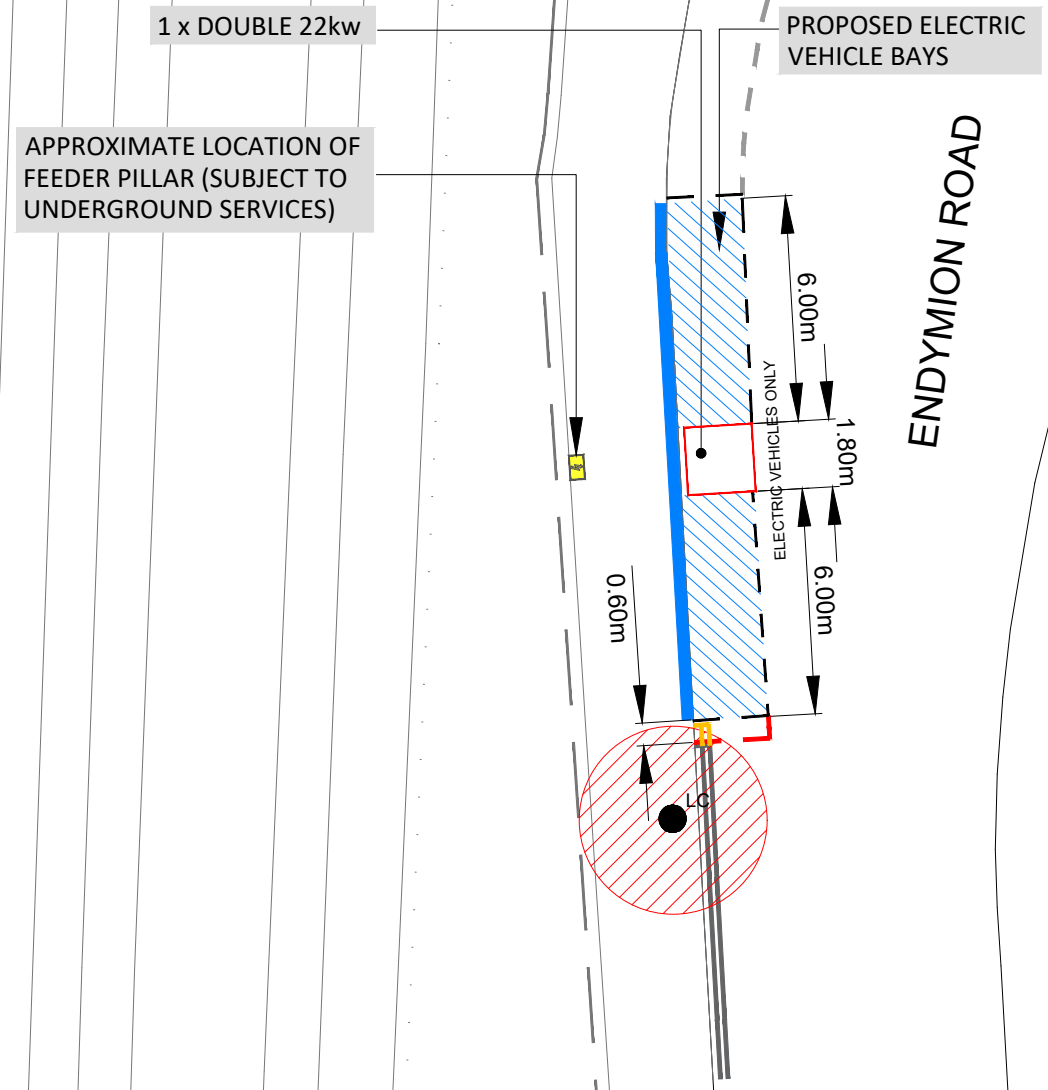
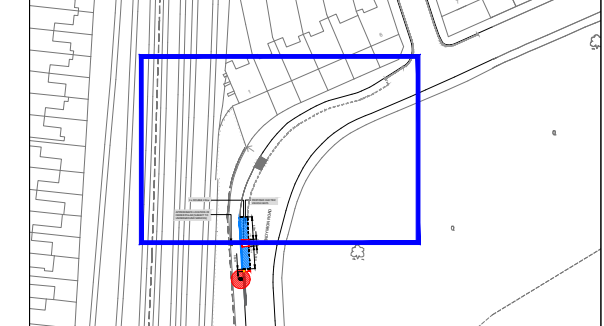

Rev.	Date	Comments	Des	Chk	App
-		ORIGINAL ISSUE			





t +44 (0)20 3318 8560    e sales@its-global.co.uk

Client :  
**LB Haringey**

Title:  
**GENERAL LAYOUT**  
TMO Drawing - EV Layouts  
Endymion Road

Drawing No. 58/1030/TMO/167	Sheet No. 1 OF 1	Rev. -
--------------------------------	---------------------	-----------

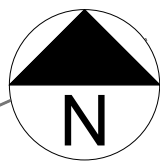
1:200 @ A3



**KEY / LEGEND**

- EXISTING - EV PARKING BAY
- OPT 1 - EV PROPOSED BAY
- NEW TRAFFIC ISLAND WITH CHARGE POINT
- EV FEDDER PILLAR
- EXISTING SOURCE LONDON CP
- BT DUCTING
- ELEC DUCTING
- BT STATUTORY PLANT
- EXISTING LAMP COLUMN
- CP EXCLUSION ZONE (2.5m Radius)
- REMOVAL
- SETTING OUT POINT

EASTINGS	531254
NORTHINGS	187836
POSTCODE	N4 4AW

**LOCATION PLAN**

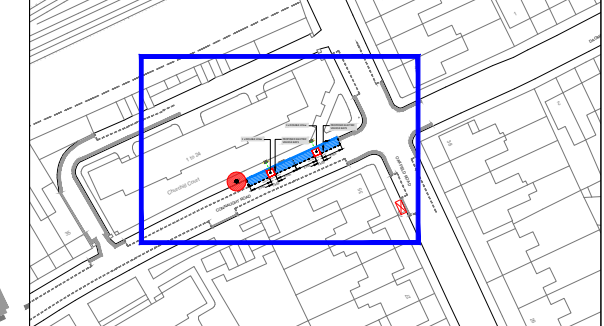

Rev.	Date	Comments	Des	Chk	App
-		ORIGINAL ISSUE			

**its**  
intelligent  
transport  
services

t +44 (0)20 3318 8560

**source**  
LONDON

e sales@its-global.co.uk

Client :  
**LB Haringey**

Title:  
**GENERAL LAYOUT**  
TMO Drawing - EV Layouts  
Connaught Road

Drawing No. 58/1030/TMO/168	Sheet No. 1 OF 1	Rev. -
--------------------------------	---------------------	-----------

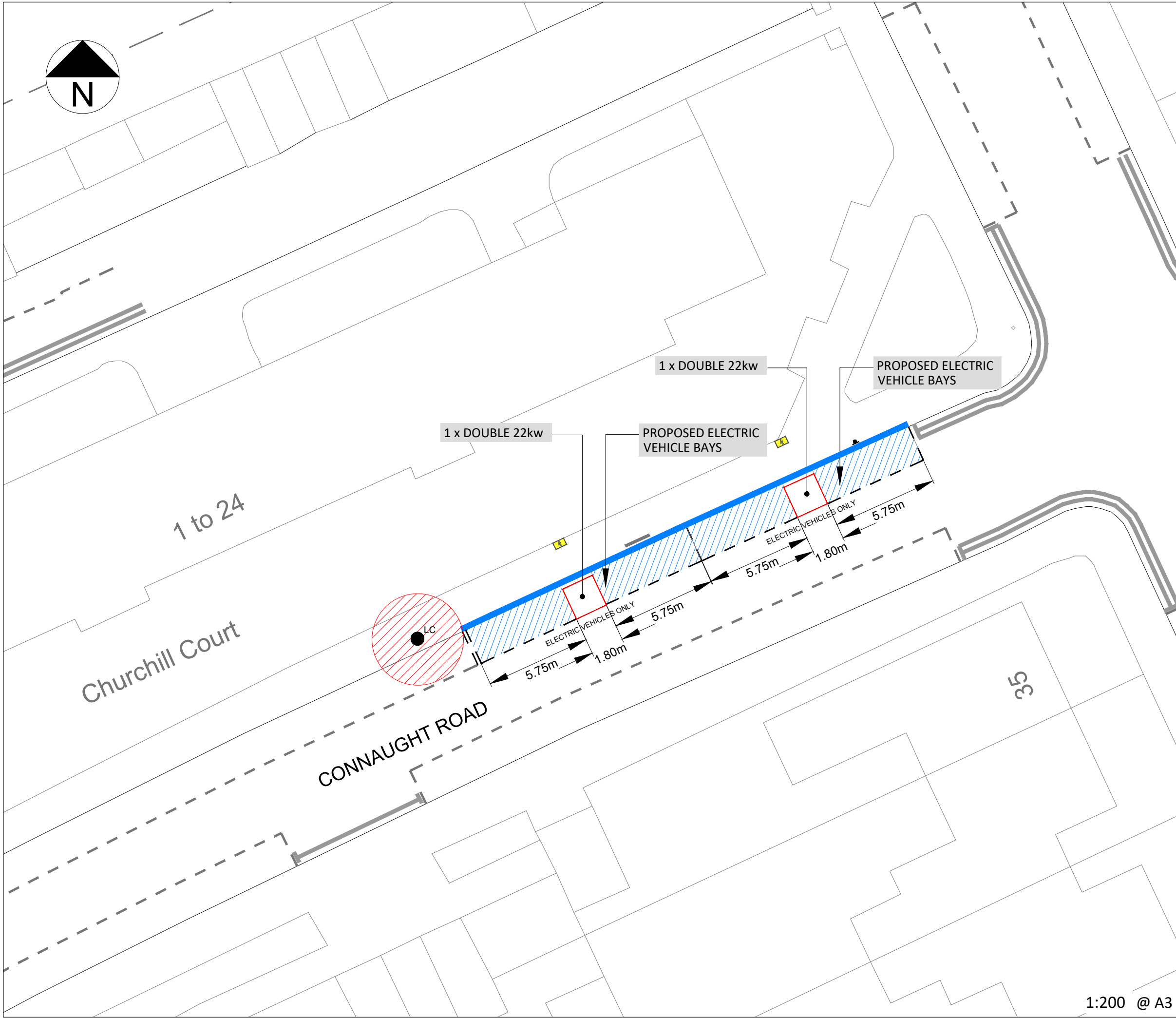

1:200 @ A3



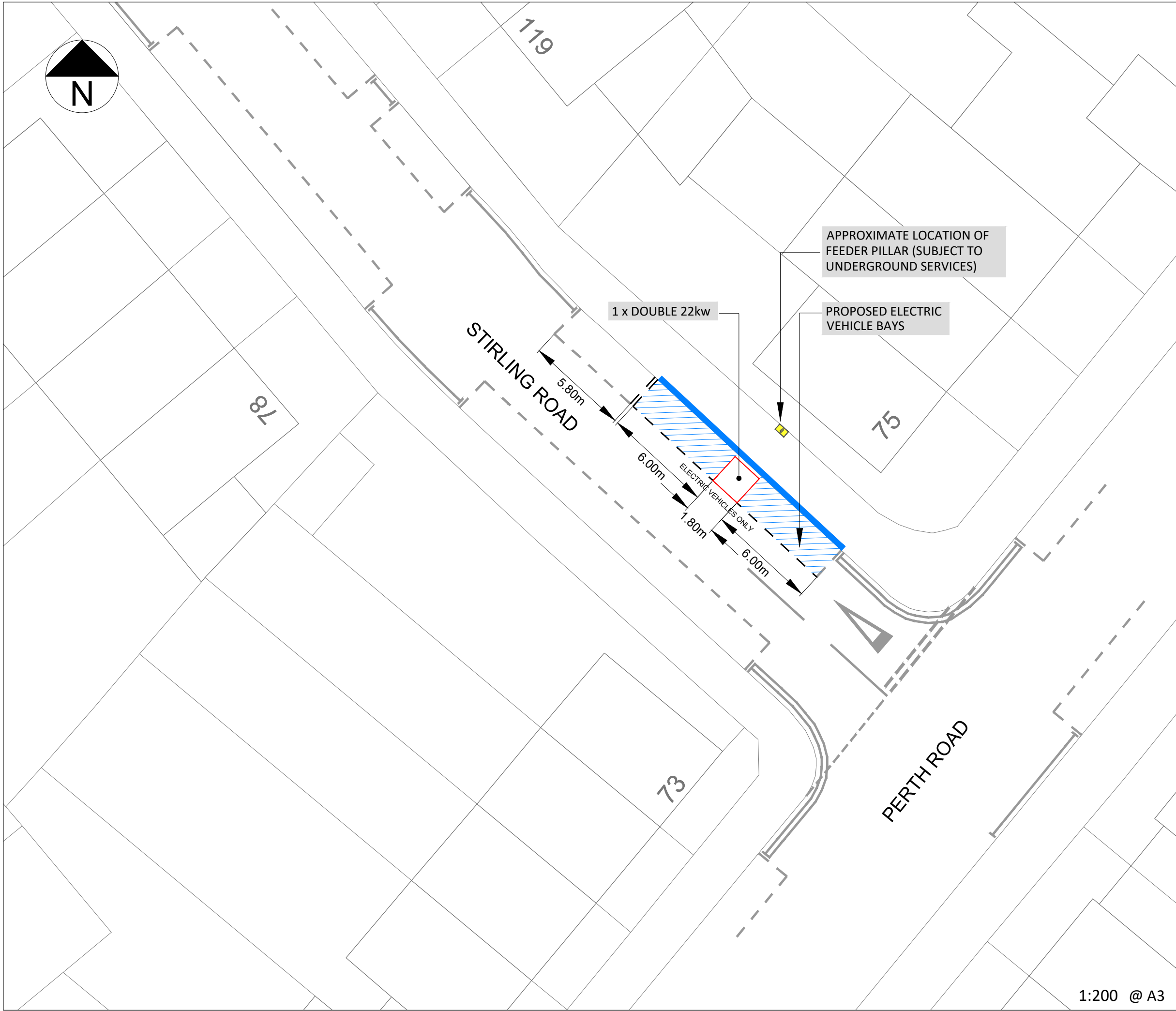
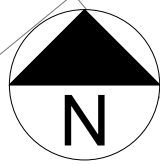

**KEY / LEGEND**

- EXISTING - EV PARKING BAY
- OPT 1 - EV PROPOSED BAY
- NEW TRAFFIC ISLAND WITH CHARGE POINT
- EV FEDDER PILLAR
- EXISTING SOURCE LONDON CP
- BT DUCTING
- ELEC DUCTING
- BT STATUTORY PLANT
- EXISTING LAMP COLUMN
- CP EXCLUSION ZONE (2.5m Radius)
- REMOVAL
- SETTING OUT POINT

EASTINGS	531799
NORTHINGS	190930
POSTCODE	N22 5BN

**LOCATION PLAN**

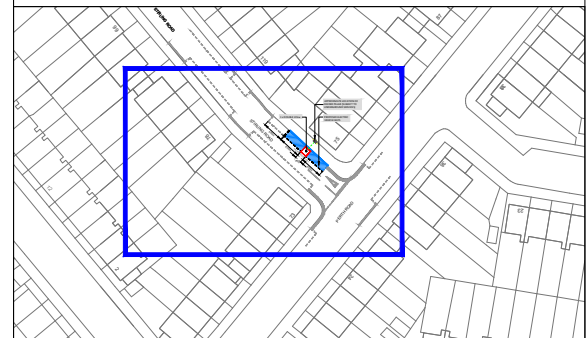

-	ORIGINAL ISSUE	Des	Chk	App
---	----------------	-----	-----	-----

Rev.	Date	Comments	Des	Chk	App
------	------	----------	-----	-----	-----

Intelligent  
transport  
services

t +44 (0)20 3318 8560

e sales@its-global.co.uk

Client :  
**LB Haringey**

Title:  
**GENERAL LAYOUT**  
TMO Drawing - EV Layouts  
Stirling Road

Drawing No. 58/1030/TMO/169	Sheet No. 1 OF 1	Rev. -
--------------------------------	---------------------	-----------

1:200 @ A3

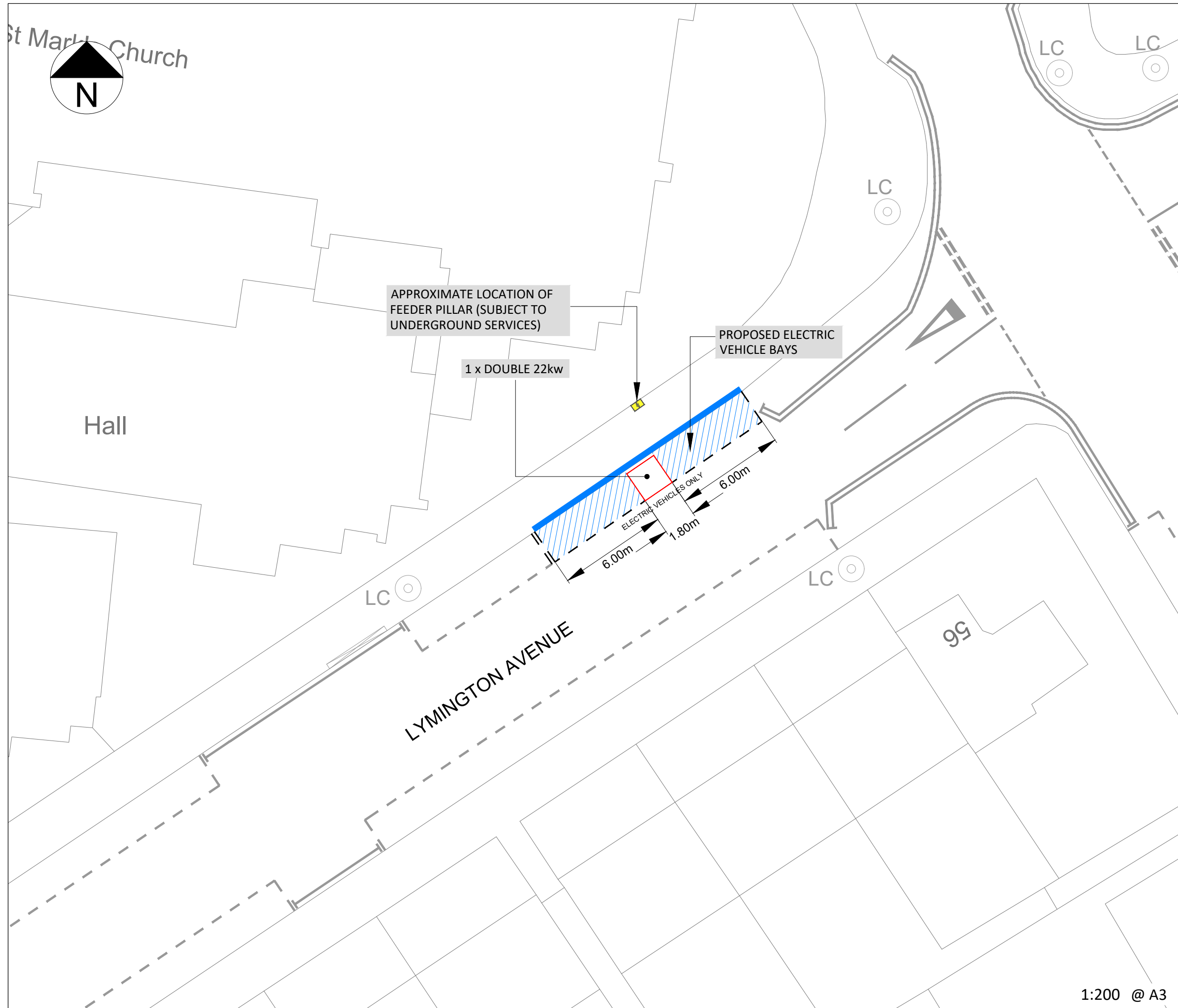

KEY / LEGEND

- EXISTING - EV PARKING BAY
- OPT 1 - EV PROPOSED BAY
- NEW TRAFFIC ISLAND WITH CHARGE POINT
- EV FEDDER PILLAR
- EXISTING SOURCE LONDON CP
- BT DUCTING
- ELEC DUCTING
- BT STATUTORY PLANT
- EXISTING LAMP COLUMN
- CP EXCLUSION ZONE (2.5m Radius)
- REMOVAL
- SETTING OUT POINT

EASTINGS	531409
NORTHINGS	190132
POSTCODE	N22 6JD

LOCATION PLAN

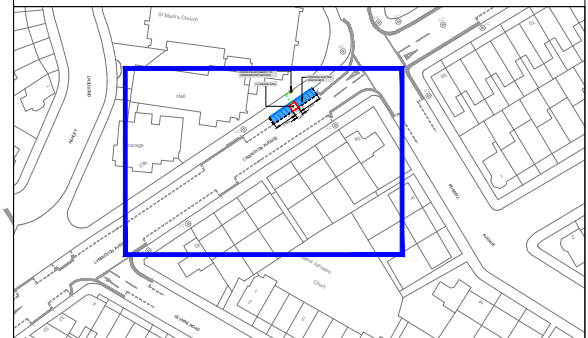

Rev.	Date	Comments	Des	Chk	App
-		ORIGINAL ISSUE			

its  
intelligent  
transport  
services

t +44 (0)20 3318 8560

source  
LONDON

e sales@its-global.co.uk

Client :  
**LB Haringey**

Title:  
**GENERAL LAYOUT**  
TMO Drawing - EV Layouts  
Lymington Road

Drawing No. 58/1030/TMO/170	Sheet No. 1 OF 1	Rev. -
--------------------------------	---------------------	-----------

1:200 @ A3

BASED UPON ORDNANCE SURVEY'S MAPS WITH THE PERMISSION OF THE CONTROLLER OF HMSO. (c) CROWN COPYRIGHT. UNAUTHORISED REPRODUCTION INFRINGES CROWN COPYRIGHT AND MAY LEAD TO PROSECUTION OR CIVIL PROCEEDINGS. XXX

CAD REFERENCE: G:\Shared drives\58-Bollore-Total\58-1030-BPL-LB Haringey\Master Filing System\02-Location Drawings\03-TMO Drawings\58-1030-TMO-170-Lymington Road - 58-1030-TMO-170 DATE: 01/11/2023

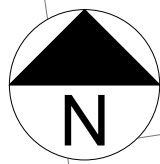

31

39

24

LINLEY ROAD

29

21

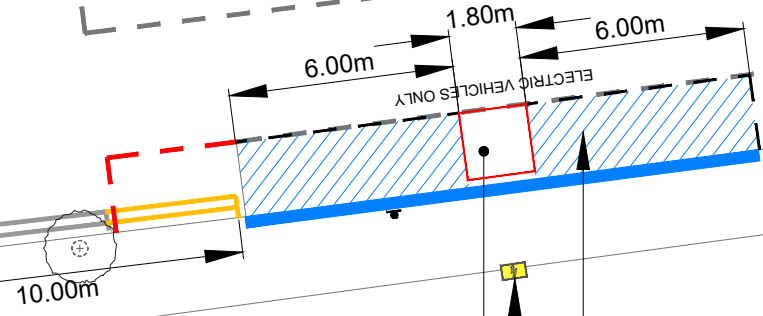

1 x DOUBLE 22kw

PROPOSED ELECTRIC VEHICLE BAYS

APPROXIMATE LOCATION OF FEEDER PILLAR (SUBJECT TO UNDERGROUND SERVICES)

### KEY / LEGEND

- EXISTING - EV PARKING BAY
- OPT 1 - EV PROPOSED BAY
- NEW TRAFFIC ISLAND WITH CHARGE POINT
- EV FEDDER PILLAR
- EXISTING SOURCE LONDON CP
- BT DUCTING
- ELEC DUCTING
- BT STATUTORY PLANT
- EXISTING LAMP COLUMN
- CP EXCLUSION ZONE (2.5m Radius)
- REMOVAL
- SETTING OUT POINT

EASTINGS	533388
NORTHINGS	190444
POSTCODE	N17 6RP

### LOCATION PLAN

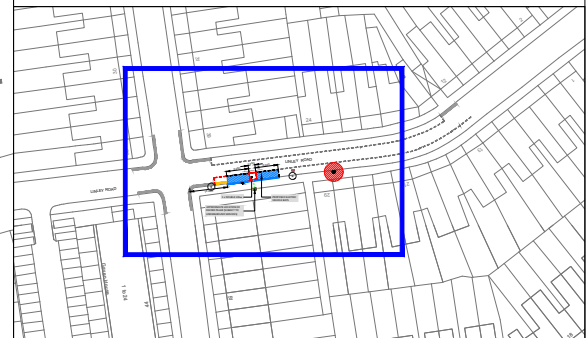

Rev.	Date	Comments	Des	Chk	App
-		ORIGINAL ISSUE			



t +44 (0)20 3318 8560 e sales@its-global.co.uk

Client :  
**LB Haringey**

Title:  
**GENERAL LAYOUT**  
TMO Drawing - EV Layouts  
Linley Road

Drawing No. 58/1030/TMO/171	Sheet No. 1 OF 1	Rev. -
--------------------------------	---------------------	-----------

1:200 @ A3

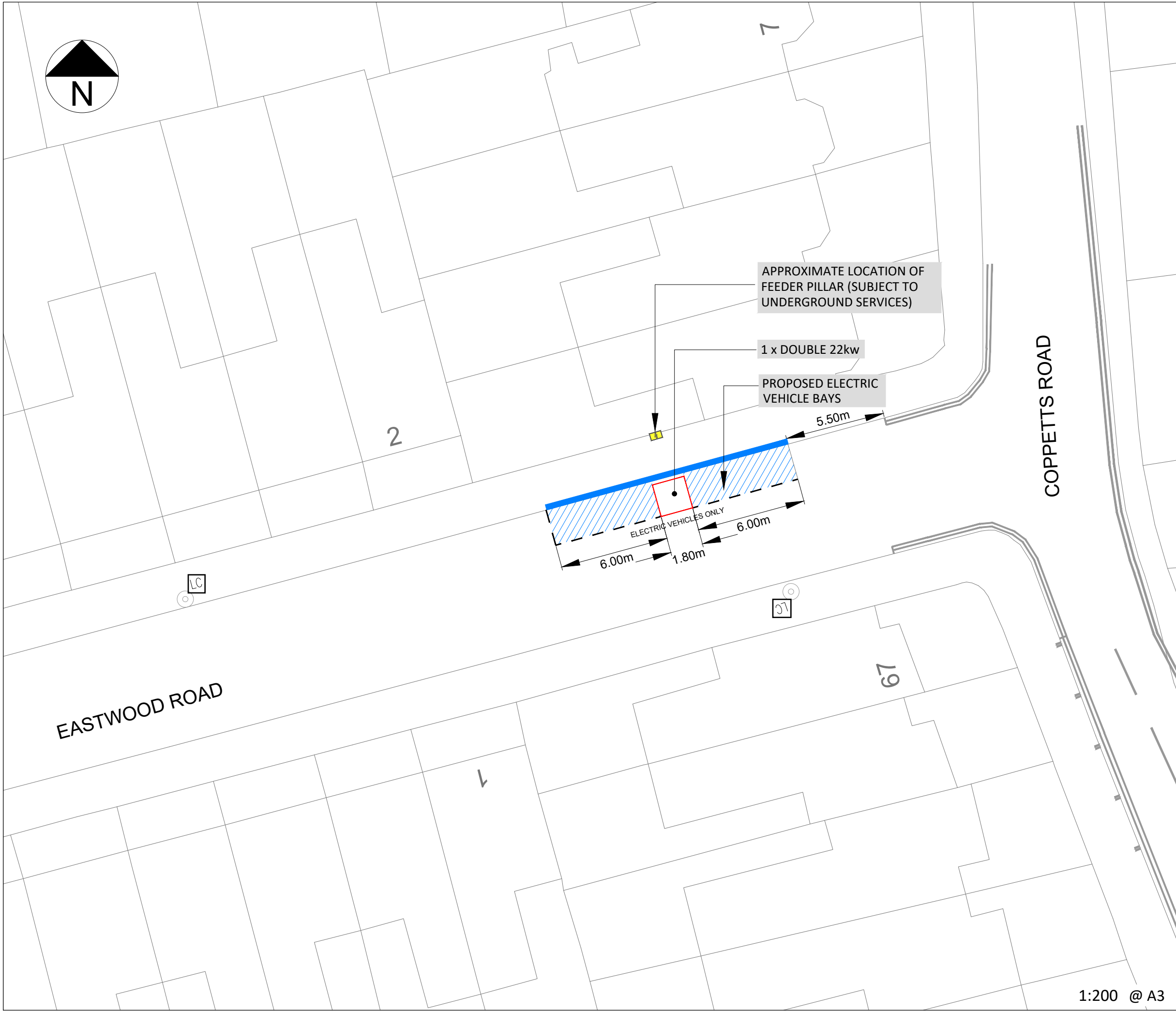
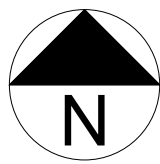

**KEY / LEGEND**

- EXISTING - EV PARKING BAY
- OPT 1 - EV PROPOSED BAY
- NEW TRAFFIC ISLAND WITH CHARGE POINT
- EV FEDDER PILLAR
- EXISTING SOURCE LONDON CP
- BT DUCTING
- ELEC DUCTING
- BT STATUTORY PLANT
- EXISTING LAMP COLUMN
- CP EXCLUSION ZONE (2.5m Radius)
- REMOVAL
- SETTING OUT POINT

EASTINGS	528192
NORTHINGS	190052
POSTCODE	N10 1NL

**LOCATION PLAN**

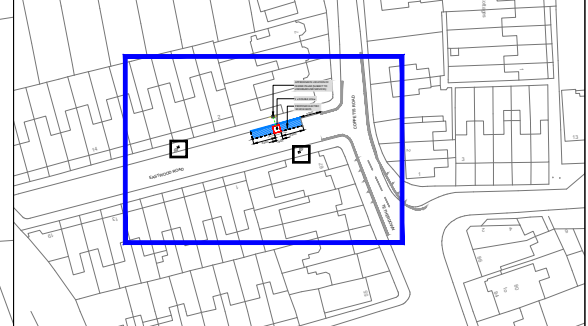

Rev.	Date	Comments	Des	Chk	App
-		ORIGINAL ISSUE			

Intelligent transport services

t +44 (0)20 3318 8560

source LONDON

e sales@its-global.co.uk

Client :  
**LB Haringey**

Title:  
**GENERAL LAYOUT**  
TMO Drawing - EV Layouts  
Eastwood Road

Drawing No. 58/1030/TMO/172	Sheet No. 1 OF 1	Rev. -
--------------------------------	---------------------	-----------

1:200 @ A3



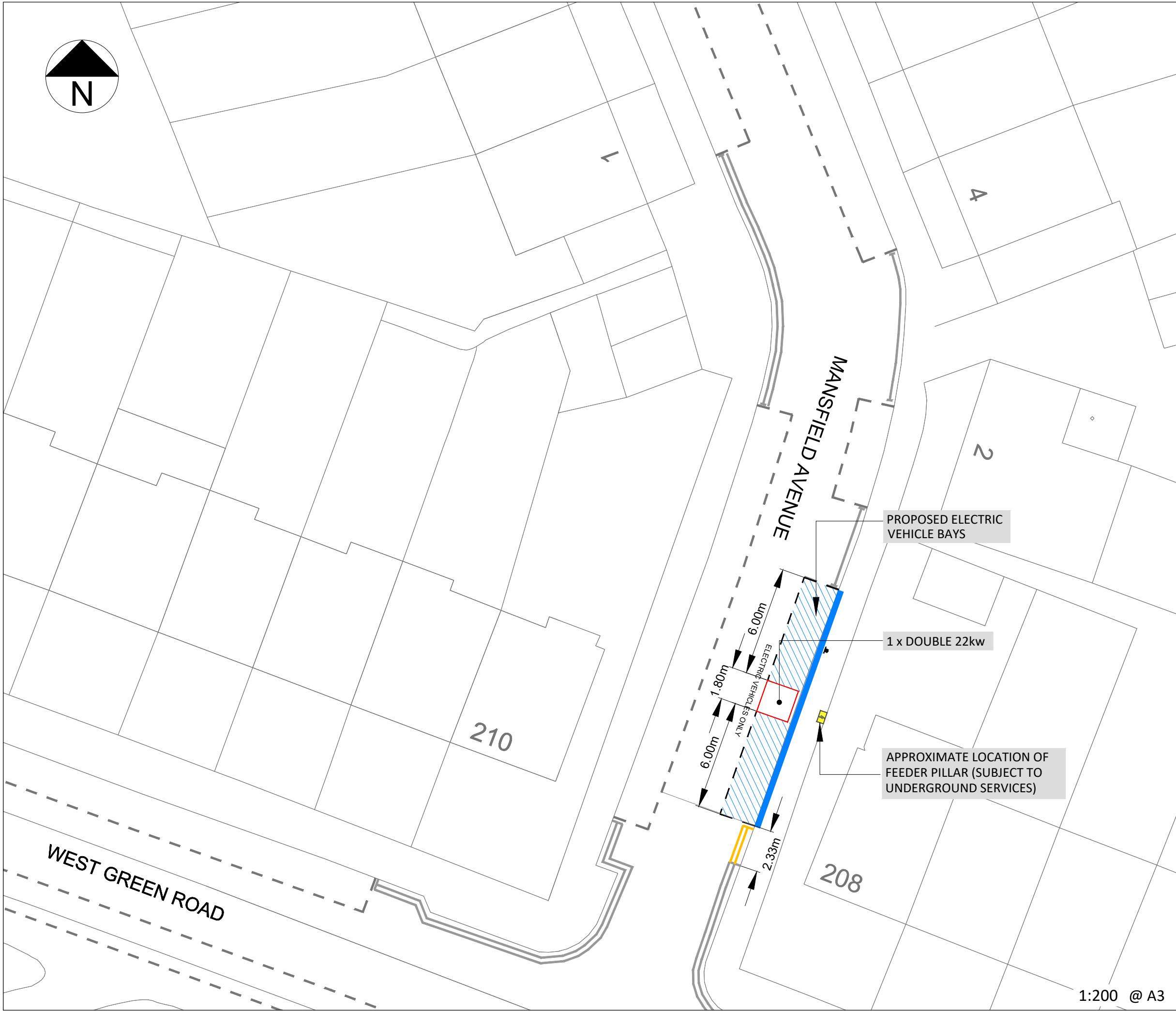

**KEY / LEGEND**

- EXISTING - EV PARKING BAY
- OPT 1 - EV PROPOSED BAY
- NEW TRAFFIC ISLAND WITH CHARGE POINT
- EV FEDDER PILLAR
- EXISTING SOURCE LONDON CP
- BT DUCTING
- ELEC DUCTING
- BT STATUTORY PLANT
- EXISTING LAMP COLUMN
- CP EXCLUSION ZONE (2.5m Radius)
- REMOVAL
- SETTING OUT POINT

EASTINGS	532784
NORTHINGS	189202
POSTCODE	N15 4HW

**LOCATION PLAN**

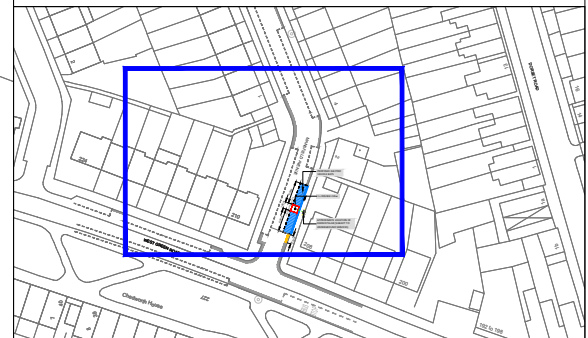

Rev.	Date	Comments	Des	Chk	App
-		ORIGINAL ISSUE			

Intelligent transport services

t +44 (0)20 3318 8560

source LONDON

e sales@its-global.co.uk

Client :  
**LB Haringey**

Title:  
**GENERAL LAYOUT**  
TMO Drawing - EV Layouts  
Mansfield Road

Drawing No. 58/1030/TMO/174	Sheet No. 1 OF 1	Rev. -
--------------------------------	---------------------	-----------

1:200 @ A3

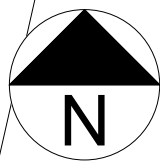

WIGHTMAN ROAD

174

HEWITT ROAD

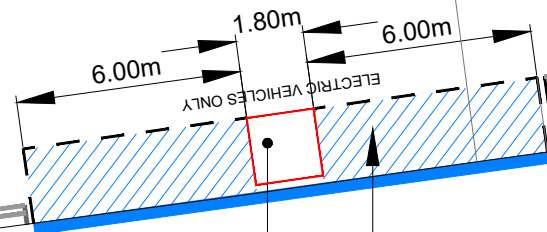

1 x DOUBLE 22kw

PROPOSED ELECTRIC VEHICLE BAYS

APPROXIMATE LOCATION OF FEEDER PILLAR (SUBJECT TO UNDERGROUND SERVICES)

172

2a

2

### KEY / LEGEND

- EXISTING - EV PARKING BAY
- OPT 1 - EV PROPOSED BAY
- NEW TRAFFIC ISLAND WITH CHARGE POINT
- EV FEDDER PILLAR
- EXISTING SOURCE LONDON CP
- BT DUCTING
- ELEC DUCTING
- BT STATUTORY PLANT
- EXISTING LAMP COLUMN
- CP EXCLUSION ZONE (2.5m Radius)
- REMOVAL
- SETTING OUT POINT

EASTINGS	531332
NORTHINGS	188746
POSTCODE	N8 0BL

### LOCATION PLAN



Rev.	Date	Comments	Des	Chk	App
-		ORIGINAL ISSUE			



t +44 (0)20 3318 8560

e sales@its-global.co.uk

Client :

LB Haringey

Title:

**GENERAL LAYOUT**  
TMO Drawing - EV Layouts  
Hewitt Road

Drawing No.  
58/1030/TMO/176

Sheet No.  
1 OF 1

Rev.  
-

1:200 @ A3

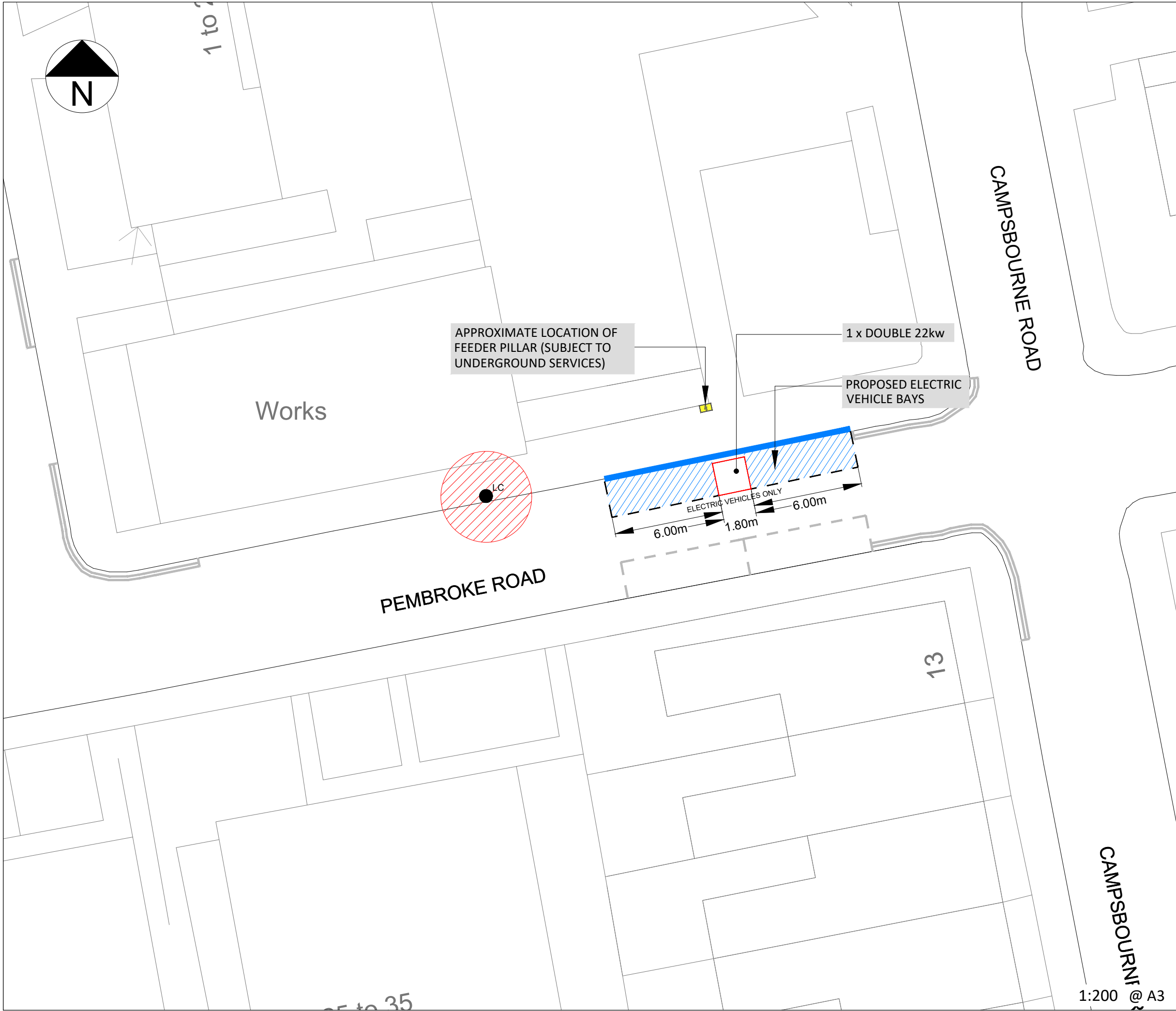

KEY / LEGEND	
EXISTING - EV PARKING BAY	
OPT 1 - EV PROPOSED BAY	
NEW TRAFFIC ISLAND WITH CHARGE POINT	
EV FEDDER PILLAR	
EXISTING SOURCE LONDON CP	
BT DUCTING	
ELEC DUCTING	
BT STATUTORY PLANT	
EXISTING LAMP COLUMN	
CP EXCLUSION ZONE (2.5m Radius)	
REMOVAL	
SETTING OUT POINT	

EASTINGS	530356
NORTHINGS	189460
POSTCODE	N87RQ

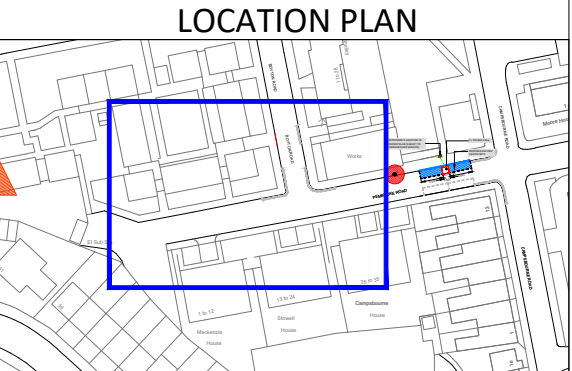

Rev.	Date	Comments	Des	Chk	App
-		ORIGINAL ISSUE			



Intelligent transport services

t +44 (0)20 3318 8560



source LONDON

e sales@its-global.co.uk

Client :  
**LB Haringey**

Title: <b>GENERAL LAYOUT</b> TMO Drawing - EV Layouts Pembroke Road		
Drawing No. 58/1030/TMO/177	Sheet No. 1 OF 1	Rev. -

1:200 @ A3