

LOCALITY PLAN

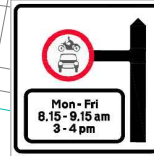

Advance warning sign to be installed west facing on existing lighting column on northern footway of Sperring Road.

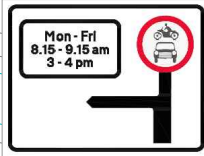

Advance warning sign to be installed south facing on existing lighting column on western footway of Moorefield Road.

Approximate Quantities
 SS Square wooden planter 1m L x 1m W x 0.6m H with reflectors - 3x
 Regular square wooden planter 1m L x 1m W x 0.9m H with reflectors - 2x
 Rectangular wooden planter 1.8m L x 1m W x 0.9m H with reflectors - 2x
 Signposts - 6x
 Bolt down kerbs - 28x
 Signs to TSRGD 618.3C, 610x 1205mm - 4x
 Camera enforcement plates - x4
 Signs to TSRGD 619, 750mm - 6x
 Signs to TSRGD 816, 750mm - 2x
 LB Haringey sign - 2x
 Except Cycles plate - 2x
 Custom Advance warning sign for SS (left) - 1x
 Custom Advance warning sign for SS (straight ahead) - 1x



Key:

- Proposed sign on existing lighting column
- Proposed School Street

- Notes:**
- Drawing based on OS base, dimensions and street furniture positions to be checked on site and any discrepancies to be reported.
 - Not all road markings shown.
 - Proposed pre-formed thermoplastic cycle markings to TSRGD diagram 1057, 1215mm, installed in a central position.
 - All planters and bollards to be equipped with reflectors.
 - Allow small gap between kerb and planter for drainage.
 - Use four bolt down kerb sections around perimeter of each planter to fix planters in place. Maintain gap between each planter and kerbside for drainage purposes. Bolt down kerb sections to be saw cut on site to required lengths.
 - Low plants to be used in planters to avoid obstructing visibility, except where trees are proposed.
 - Signs to be mounted with anti-rotational fixings at 2.3m minimum height, except where stated otherwise.

- General Notes:**
- All dimensions in metres, unless otherwise noted.
 - Do not scale off plan.
 - Dimensions are to be checked by the contractor prior to commencement of work. Any discrepancy shall be reported immediately to Sustrans.
 - Drawing based on OS base plan.
 - Co-ordinates based on OS grid.
 - Levels based on OS datum (Newlyn).
 - This drawing is to be read in conjunction with all other relevant drawings and specifications.
 - All work shall be carried out in accordance with LB Haringey statutory authority and health & safety requirements and regulations.
 - The position of services is based on information provided by other parties at the time of design and is for guidance only. It is the responsibility of the Client and Contractor to verify the exact position of any services before commencing works on site.
 - Temporary traffic works must be undertaken in accordance with Chapter 8 parts 1 & 2 of the Traffic Signs Manual, Safety at Street Works and Road Works Code of Practice 2013 and any other relevant H&S legislation.
 - These drawings have been produced under the CDM 2015 Regulations. The client is directed to their duties under Regulation 4 of CDM 2015.
 - The delivery of this drawing in electronic format shall not be construed to provide any authorisation or right of the recipient or any other person to rely upon, alter or otherwise use the information provided. Any use of this information is at the sole risk and liability of the user and Sustrans assumes no liability for unauthorised use or alteration of the information contained herein.
 - To ensure the most up to date drawings are being used the project drawing register should be referred to.
 - For further information on drawing and design revisions, see decision log or contact Sustrans project manager.
 - This drawing has been produced to be read in colour, for the sheet size specified below. Printing or copying in black and white, or on a different sheet size may lead to misinterpretation of the design.

B	LB Haringey design comments	LC	ZH	GF	31/01/2022
A	LB Haringey design comments	LC	ZH	GF	26/01/2022

sustrans
 JOIN THE MOVEMENT
 244-254 Cambridge Heath Rd, London E2 9DA
 020 7017 2350 www.sustrans.org.uk

Project: Bruce Grove Design

Title: Sperring Road School Street Area A
 Advanced Signage
 Page 1 of 4

Drawn: BM	Check: ZH	Appr: GF	Date: 07/12/2021	Scale at A3: 1:1000
------------------	------------------	-----------------	-------------------------	----------------------------

Status: **CONCEPT**

Drawing No: BGW-C-07-00-01	Revision: B
-----------------------------------	--------------------

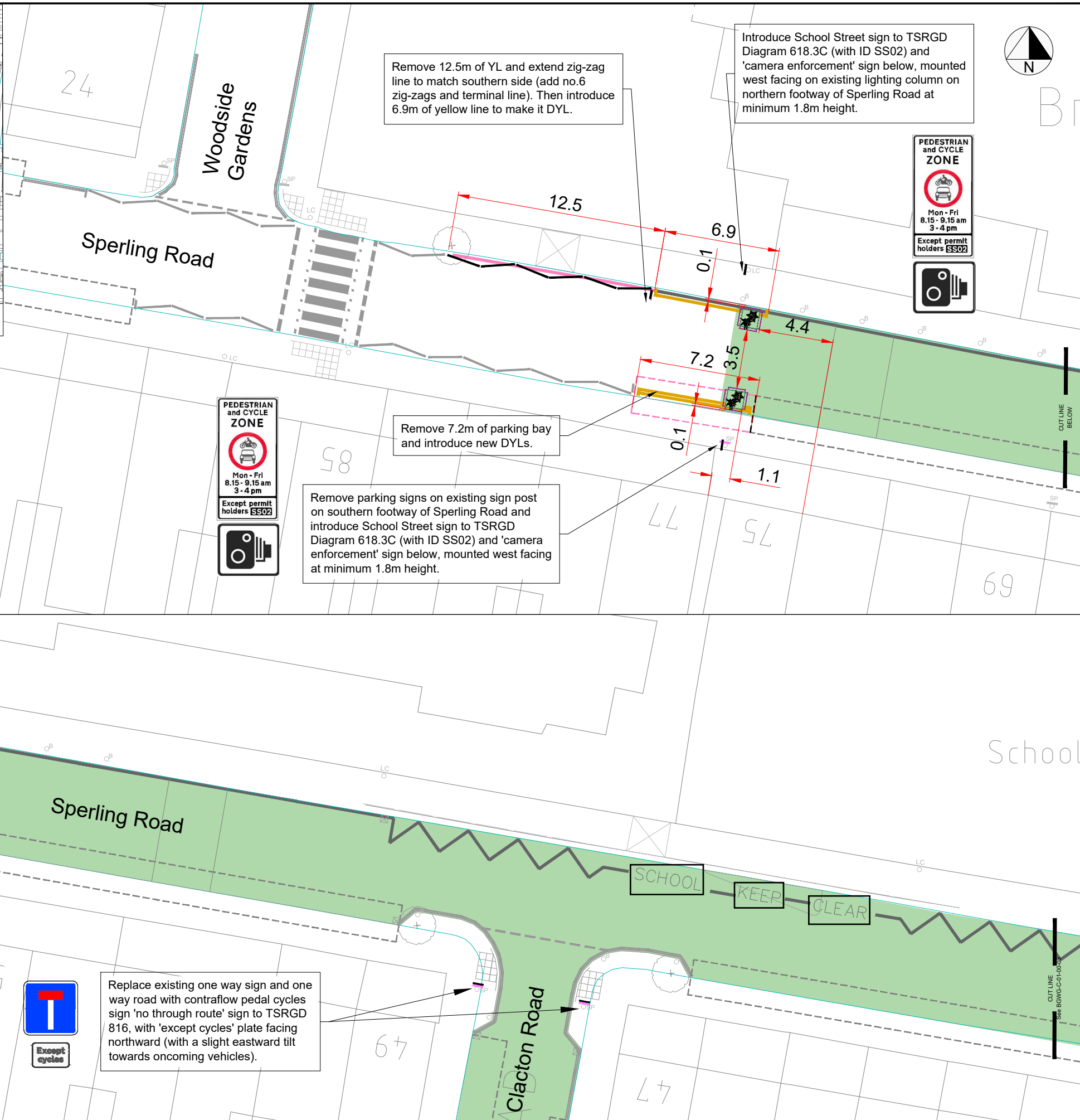
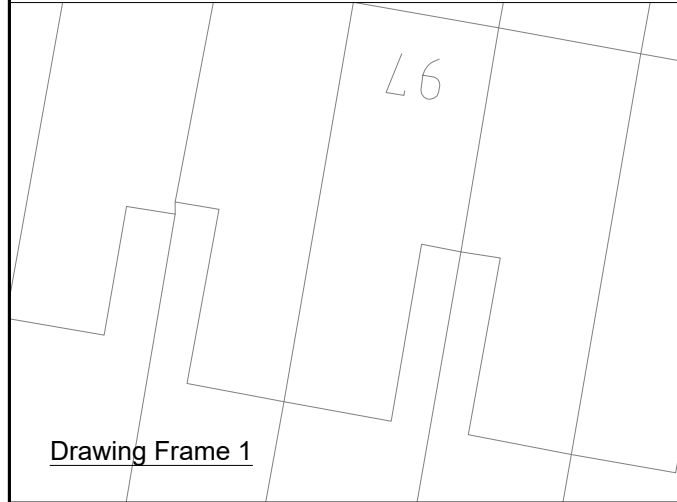
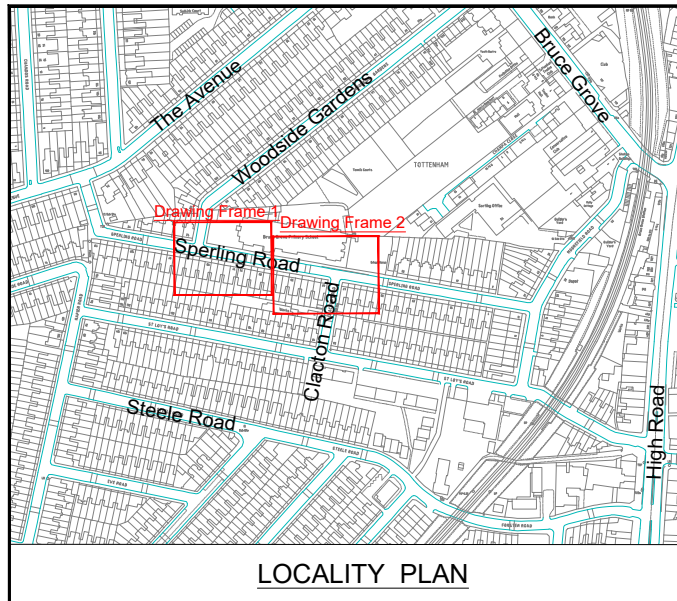

Key:

	Existing kerb line (OS base)
	Existing gully
	Existing lighting column/sign post/bollard
	Existing crossover
	Existing line marking
	Existing tactile paving
	Proposed sign post and sign/Proposed sign on existing sign post/Removing existing sign post
	Proposed white line marking
	Proposed yellow line marking
	Removal of existing line marking
	Proposed rectangular bolt down kerbs - 0.914m L x 0.15m W x 0.1m H (Redweld Harlow Kerbs)
	Proposed square wooden planter 1m L x 1m W x 0.6m H with reflectors
	Proposed school street

- Notes:**
- Drawing based on OS base, dimensions and street furniture positions to be checked on site and any discrepancies to be reported.
 - Not all road markings shown.
 - Proposed pre-formed thermoplastic cycle markings to TSRGD diagram 1057, 1215mm, installed in a central position.
 - All planters and bollards to be equipped with reflectors.
 - Allow small gap between kerb and planter for drainage.
 - Use four bolt down kerb sections around perimeter of each planter to fix planters in place. Maintain gap between each planter and kerbside for drainage purposes. Bolt down kerb sections to be saw cut on site to required lengths.
 - Low plants to be used in planters to avoid obstructing visibility, except where trees are proposed.
 - Signs to be mounted with anti-rotational fixings at 2.3m minimum height, except where stated otherwise.
 - Aerial fire engine (12m long) tracked at junction with Woodside Gardens at 3km/h. Dry steering used.
 - Refuse vehicle tracked at Clacton Road junction at 3km/h. No dry steering used.

- General Notes:**
- All dimensions in metres, unless otherwise noted.
 - Do not scale off plan.
 - Dimensions are to be checked by the contractor prior to commencement of work. Any discrepancy shall be reported immediately to Sustrans.
 - Drawing based on OS base plan.
 - Co-ordinates based on OS grid.
 - Levels based on OS datum (Newlyn).
 - This drawing is to be read in conjunction with all other relevant drawings and specifications.
 - All work shall be carried out in accordance with LB Haringey statutory authority and health & safety requirements and regulations.
 - The position of services is based on information provided by other parties at the time of design and is for guidance only. It is the responsibility of the Client and Contractor to verify the exact position of any services before commencing works on site.
 - Temporary traffic works must be undertaken in accordance with Chapter 8 parts 1 & 2 of the Traffic Signs Manual, Safety at Street Works and Road Works Code of Practice 2013 and any other relevant H&S legislation.
 - These drawings have been produced under the CDM 2015 Regulations. The client is directed to their duties under Regulation 4 of CDM 2015.
 - The delivery of this drawing in electronic format shall not be construed to provide any authorisation or right of the recipient or any other person to rely upon, alter or otherwise use the information provided. Any use of this information is at the sole risk and liability of the user and Sustrans assumes no liability for unauthorised use or alteration of the information contained herein.
 - To ensure the most up to date drawings are being used the project drawing register should be referred to.
 - For further information on drawing and design revisions, see decision log or contact Sustrans project manager.
 - This drawing has been produced to be read in colour, for the sheet size specified below. Printing or copying in black and white, or on a different sheet size may lead to misinterpretation of the design.

B	LB Haringey design comments	LC	ZH	GF	31/01/2022
A	LB Haringey design comments	LC	ZH	GF	26/01/2022

sustrans
 JOIN THE MOVEMENT
 244-254 Cambridge Heath Rd, London E2 9DA
 020 7017 2350 www.sustrans.org.uk

Project:
 Bruce Grove Design

Title:
 Spering Road School Street
 Area A
 Page 2 of 4

Drawn: Check: Appr: **Date:** 07/12/2021 **Scale at A3:** 1:250

Status:
CONCEPT

Drawing No: BGW-C-07-00-02 **Revision:** B

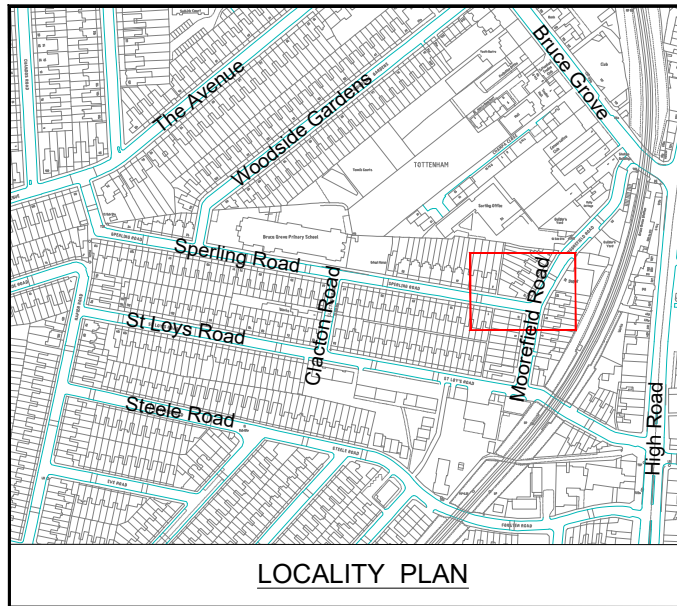

LOCALITY PLAN

Proposed school street gateway with one square planter equipped with reflectors, installed westside the existing tactile paving and with a gap of 4.8m from opposite kerbline.

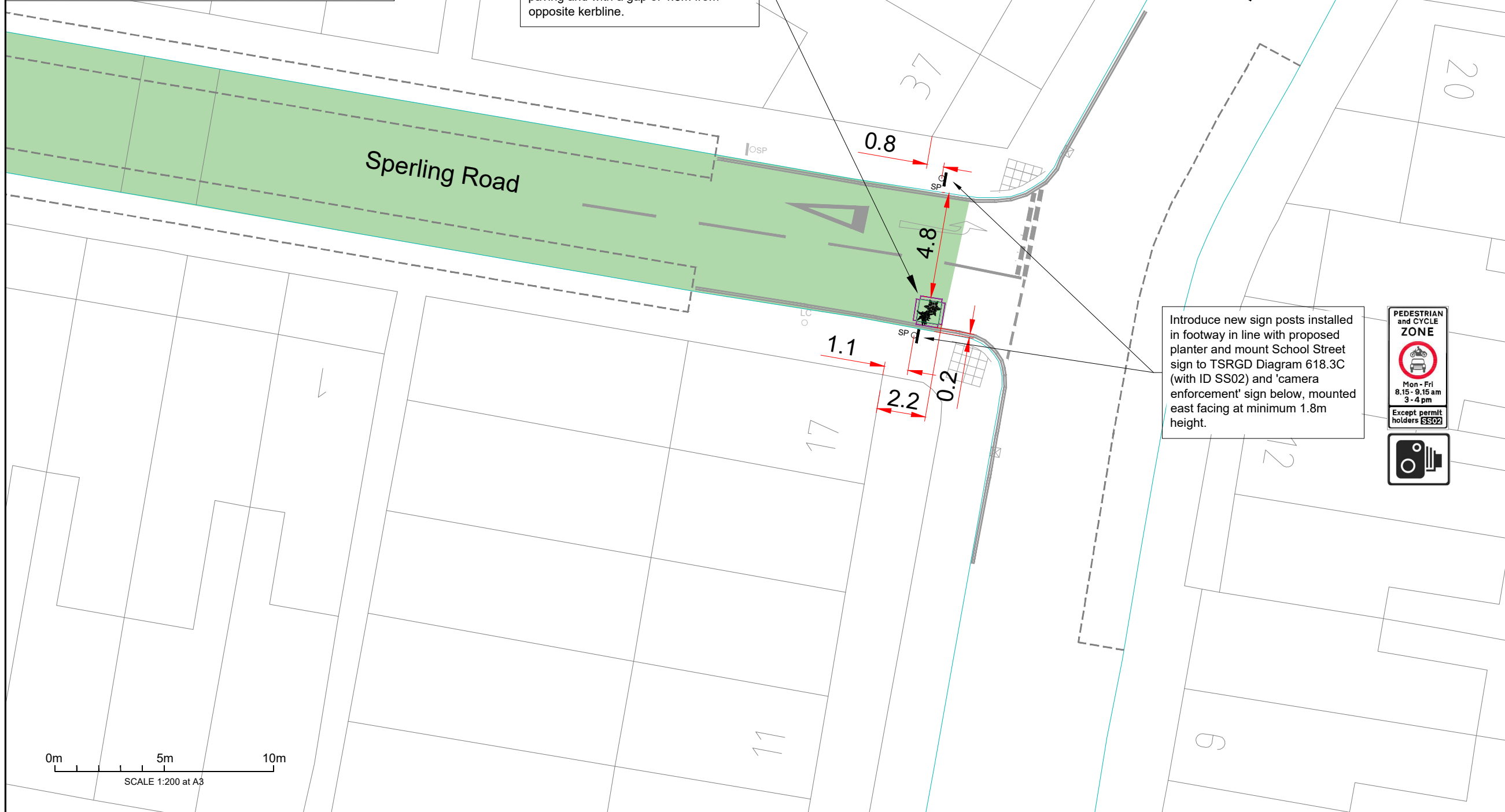

Introduce new sign posts installed in footway in line with proposed planter and mount School Street sign to TSRGD Diagram 618.3C (with ID SS02) and 'camera enforcement' sign below, mounted east facing at minimum 1.8m height.



- Key:**
- Existing kerb line (OS base)
 - Existing gully
 - Existing lighting column/sign post/bollard
 - Existing crossover
 - Existing line marking
 - Existing tactile paving
 - Proposed sign post and sign/Proposed sign on existing sign post/Remove existing sign post
 - Proposed white line marking
 - Proposed rectangular bolt down kerbs - 0.914m L x 0.15m W x 0.1m H (Redweld Harlow Kerbs)
 - Proposed square wooden planter 1m L x 1m W x 0.6m H with reflectors
 - Proposed school street

- Notes:**
1. Drawing based on OS base, dimensions and street furniture positions to be checked on site and any discrepancies to be reported.
 2. Not all road markings shown.
 3. Proposed pre-formed thermoplastic cycle markings to TSRGD diagram 1057, 1215mm, installed in a central position.
 4. All planters and bollards to be equipped with reflectors.
 5. Allow small gap between kerb and planter for drainage.
 6. Use four bolt down kerb sections around perimeter of each planter to fix planters in place. Maintain gap between each planter and kerbside for drainage purposes. Bolt down kerb sections to be saw cut on site to required lengths.
 7. Low plants to be used in planters to avoid obstructing visibility, except where trees are proposed.
 8. Signs to be mounted with anti-rotational fixings at 2.3m minimum height, except where stated otherwise.
 9. Refuse vehicle tracked at Moorefield Road junction at 3km/h. No dry steering used.

- General Notes:**
1. All dimensions in metres, unless otherwise noted.
 2. Do not scale off plan.
 3. Dimensions are to be checked by the contractor prior to commencement of work. Any discrepancy shall be reported immediately to Sustrans.
 4. Drawing based on OS base plan.
 5. Co-ordinates based on OS grid.
 6. Levels based on OS datum (Newlyn).
 7. This drawing is to be read in conjunction with all other relevant drawings and specifications.
 8. All work shall be carried out in accordance with LB Haringey statutory authority and health & safety requirements and regulations.
 9. The position of services is based on information provided by other parties at the time of design and is for guidance only. It is the responsibility of the Client and Contractor to verify the exact position of any services before commencing works on site.
 10. Temporary traffic works must be undertaken in accordance with Chapter 8 parts 1 & 2 of the Traffic Signs Manual, Safety at Street Works and Road Works Code of Practice 2015 and any other relevant H&S legislation.
 11. These drawings have been produced under the CDM 2015 Regulations. The client is directed to their duties under Regulation 4 of CDM 2015.
 12. The delivery of this drawing in electronic format shall not be construed to provide any authorisation or right of the recipient or any other person to rely upon, alter or otherwise use the information provided. Any use of this information is at the sole risk and liability of the user and Sustrans assumes no liability for unauthorised use or alteration of the information contained herein.
 13. To ensure the most up to date drawings are being used the project drawing register should be referred to.
 14. For further information on drawing and design revisions, see decision log or contact Sustrans project manager.
 15. This drawing has been produced to be read in colour, for the sheet size specified below. Printing or copying in black and white, or on a different sheet size may lead to misinterpretation of the design.

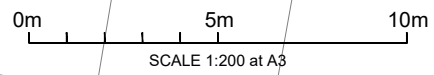

B	LB Haringey design comments	LC	ZH	GF	31/01/2022
A	LB Haringey design comments	LC	ZH	GF	26/01/2022

sustrans
 JOIN THE MOVEMENT
 244-254 Cambridge Heath Rd, London E2 9DA
 020 7017 2350 www.sustrans.org.uk

Project: Bruce Grove Design

Title: Sperling Road School Street Area A
 Page 3 of 4

Drawn: Check: Appr: Date: Scale at A3:
 BM ZH GF 07/12/2021 1:250

Status: CONCEPT

Drawing No: BGW-C-07-00-03 **Revision:** B

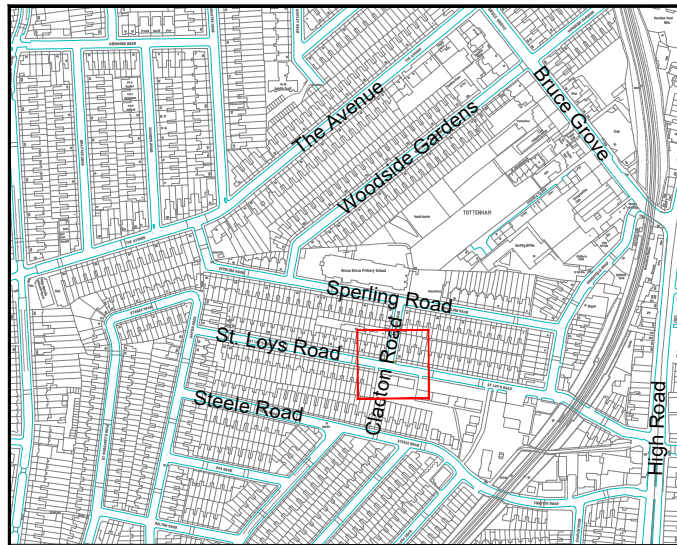

LOCALITY PLAN

Remove 11.0m of existing parking on both sides of road.

Proposed physical filter with two square planters equipped with reflectors, installed with a 1.3m gap from kerblines and a 1.5m gap from each other. Mount sign to TSRGD Diag 619 750mm on the western planter and LB Haringey sign on the eastern planter, both on the south face of planters.

Proposed physical filter with two rectangular planters equipped with reflectors, installed in carriageway with a 1.5m gap from each other. Mount sign to TSRGD Diag 619 750mm on the eastern planter and LB Haringey sign on the western planter, both on the north face of planters.

Install new sign posts with motor vehicles prohibited signs to TSRGD Diag 619 750mm mounted facing northward.

Introduce tactile paving to east and west footways of Clacton Road junction with St. Loys Road.

Remove existing 'No Entry' signs and introduce signs with motor vehicles prohibited signs to TSRGD Diag 619 750mm. Retain existing 'except cycles' plate.



- Key:**
- Existing kerb line (OS base)
 - Existing gully
 - Existing lighting column/sign post
 - Existing crossover
 - Existing line marking
 - Proposed tactile paving
 - Proposed sign post and sign/Proposed sign on existing sign post/Remove existing sign
 - Proposed yellow line marking
 - Proposed white line marking
 - Proposed rectangular bolt down kerbs - 0.914m L x 0.15m W x 0.1m H (Redweld Harlow Kerbs)
 - Proposed square wooden planter 1m L x 1m W x 0.6m H with reflectors
 - Proposed rectangular wooden planter 1.8m L x 1m W x 0.6m H with reflectors
 - Removal of existing line marking
 - Proposed school street

- Notes:**
1. Drawing based on OS base, dimensions and street furniture positions to be checked on site and any discrepancies to be reported.
 2. Not all road markings shown.
 3. Proposed pre-formed thermoplastic cycle markings to TSRGD diagram 1057, 1215mm, installed in a central position.
 4. All planters and bollards to be equipped with reflectors.
 5. Allow small gap between kerb and planter for drainage
 6. Use four bolt down kerb sections around perimeter of each planter to fix planters in place. Maintain gap between each planter and kerbside for drainage purposes. Bolt down kerb sections to be saw cut on site to required lengths.
 7. Low plants to be used in planters to avoid obstructing visibility, except where trees are proposed.
 8. Signs to be mounted with anti-rotational fixings at 2.3m minimum height, except where stated otherwise.

- General Notes:**
1. All dimensions in metres, unless otherwise noted.
 2. Do not scale off plan.
 3. Dimensions are to be checked by the contractor prior to commencement of work. Any discrepancy shall be reported immediately to Sustrans.
 4. Drawing based on OS base plan.
 5. Co-ordinates based on OS grid.
 6. Levels based on OS datum (Newlyn).
 7. This drawing is to be read in conjunction with all other relevant drawings and specifications.
 8. All work shall be carried out in accordance with LB Haringey statutory authority and health & safety requirements and regulations.
 9. The position of services is based on information provided by other parties at the time of design and is for guidance only. It is the responsibility of the Client and Contractor to verify the exact position of any services before commencing works on site.
 10. Temporary traffic works must be undertaken in accordance with Chapter 8 parts 1 & 2 of the Traffic Signs Manual, Safety at Street Works and Road Works Code of Practice 2013 and any other relevant H&S legislation.
 11. These drawings have been produced under the CDM 2015 Regulations. The client is directed to their duties under Regulation 4 of CDM 2015.
 12. The delivery of this drawing in electronic format shall not be construed to provide any authorisation or right of the recipient or any other person to rely upon, alter or otherwise use the information provided. Any use of this information is at the sole risk and liability of the user and Sustrans assumes no liability for unauthorised use or alteration of the information contained herein.
 13. To ensure the most up to date drawings are being used the project drawing register should be referred to.
 14. For further information on drawing and design revisions, see decision log or contact Sustrans project manager.
 15. This drawing has been produced to be read in colour, for the sheet size specified below. Printing or copying in black and white, or on a different sheet size may lead to misinterpretation of the design.

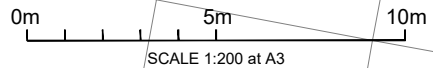

B	LB Haringey design comments	LC	ZH	GF	31/01/2022
A	LB Haringey design comments	LC	ZH	GF	26/01/2022

sustrans
JOIN THE MOVEMENT
244-254 Cambridge Heath Rd, London E2 9DA
020 7017 2350 www.sustrans.org.uk

Project: Bruce Grove Design

Title: Spurling Road School Street Area A
Page of 4

Drawn: BM **Check:** ZH **Appr:** GF **Date:** 07/12/2021 **Scale at A3:** 1:250

Status: CONCEPT

Drawing No: BGW-C-07-00-04 **Revision:** B

DRAFT

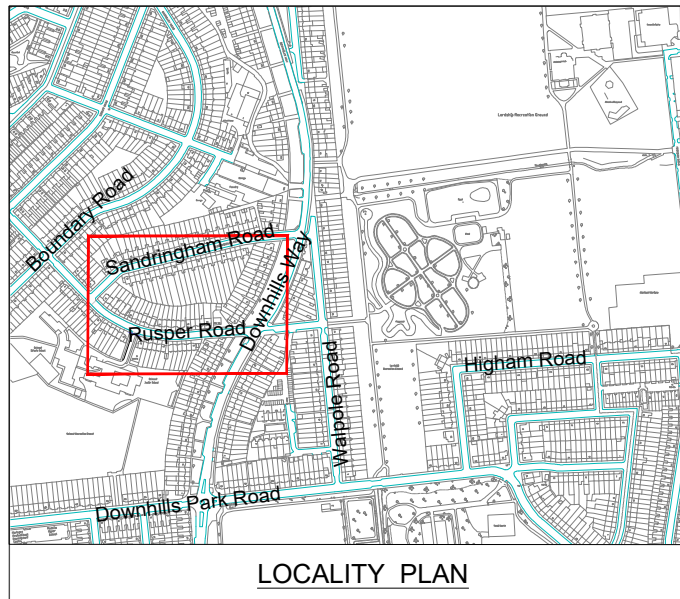
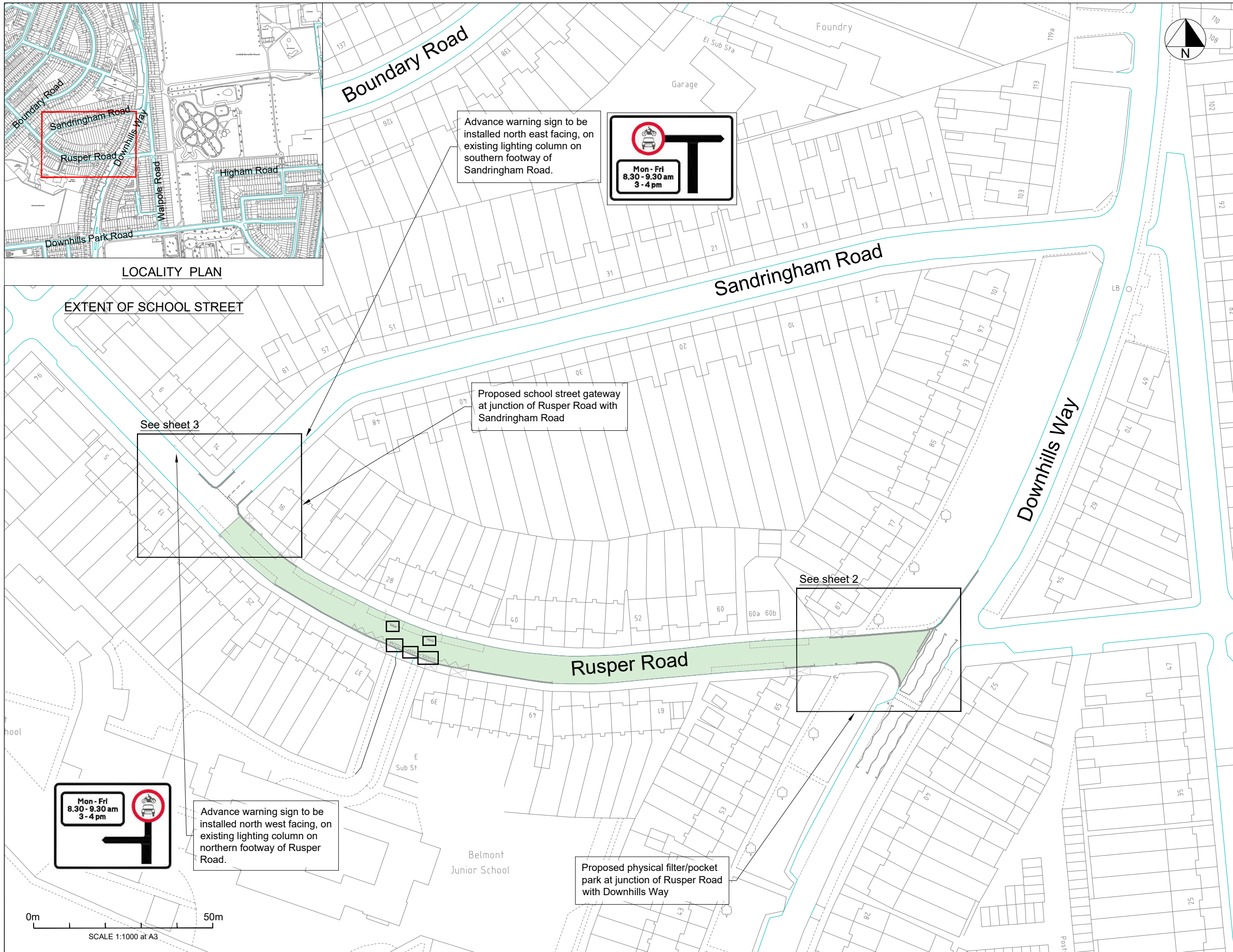

LOCALITY PLAN

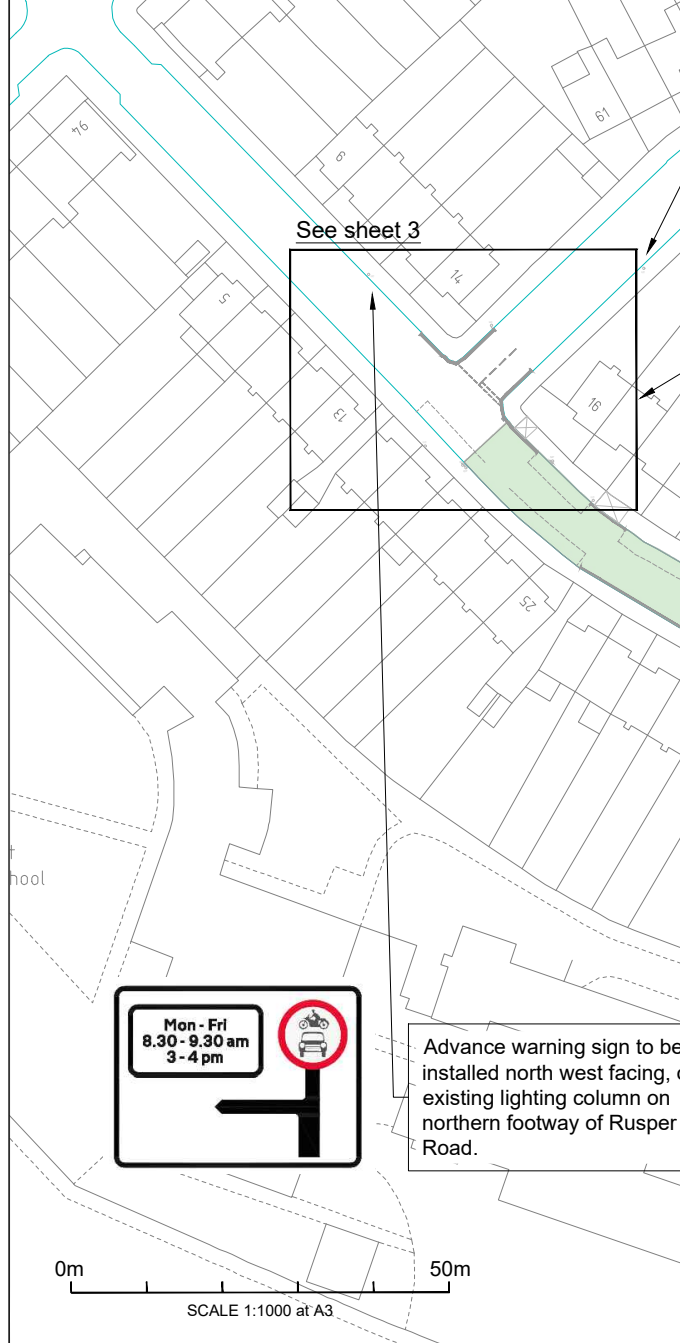

EXTENT OF SCHOOL STREET

Advance warning sign to be installed north east facing, on existing lighting column on southern footway of Sandringham Road.

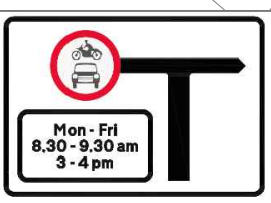

Proposed school street gateway at junction of Rusper Road with Sandringham Road

See sheet 3

See sheet 2

Advance warning sign to be installed north west facing, on existing lighting column on northern footway of Rusper Road.

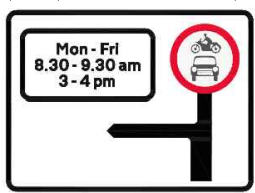

Proposed physical filter/pocket park at junction of Rusper Road with Downhills Way

- Key:**
- Existing kerb line (OS base)
 - Existing gully/existing tree
 - Existing lighting column/sign post/bollard
 - Existing crossover
 - Existing line marking
 - Proposed School Street
 - Proposed sign on existing lighting column

- Approximate Quantities**
- Square SS planter with reflectors 1m x 1m x 0.6m - 2x
 - Rectangular planter with reflectors 1.8m x 1m x 0.9m - 6x
 - Collapsible bollard with reflectors - 1x
 - Roundel to TSRGD 955 (150mm) - 1x
 - Bolt down Kerbs - 32x
 - Signposts - 3x
 - Signs to TSRGD 618.3C, ID SS20 - 2x
 - Camera enforcement plates - x2
 - Custom Advance warning sign for SS (no left) - 1x
 - Custom Advance warning sign for SS (no ahead) - 1x
 - Signs to TSRGD 619, 750mm - 7x
 - Signs to TSRGD 816 - 2x
 - Except cycles plates - 2x
 - ANPR Camera - 1x

- Notes:**
1. Drawing based on OS base, dimensions and street furniture positions to be checked on site and any discrepancies to be reported.
 2. Not all road markings shown.
 3. Proposed cycle markings to TSRGD 1057, 1215mm to be pre-formed thermoplastic
 4. All planters and bollards to be equipped with reflectors.
 5. Use four bolt down kerb sections around perimeter of each planter to fix planters in place. Maintain gap between each planter and kerbside for drainage purposes. Bolt down kerb sections to be saw cut on site to required lengths.
 6. Low plants to be used in planters to avoid obstructing visibility, except where trees are proposed.
 7. Signs to be mounted with anti-rotational fixings at 2.3m minimum height except where stated otherwise.
 8. Total parking loss 22m
 9. Sweep path analysis undertaken indicates 3-axle refuse vehicle (8.74m long) can access all properties.

- General Notes:**
1. All dimensions in metres, unless otherwise noted.
 2. Do not scale off plan.
 3. Dimensions are to be checked by the contractor prior to commencement of work. Any discrepancy shall be reported immediately to Sustrans.
 4. Drawing based on OS base plan.
 5. Co-ordinates based on OS grid.
 6. Levels based on OS datum (Newlyn).
 7. This drawing is to be read in conjunction with all other relevant drawings and specifications.
 8. All work shall be carried out in accordance with LB Haringey statutory authority and health & safety requirements and regulations.
 9. The position of services is based on information provided by other parties at the time of design and is for guidance only. It is the responsibility of the Client and Contractor to verify the exact position of any services before commencing works on site.
 10. Temporary traffic works must be undertaken in accordance with Chapter 8 parts 1 & 2 of the Traffic Signs Manual, Safety at Street Works and Road Works Code of Practice 2013 and any other relevant H&S legislation.
 11. These drawings have been produced under the CDM 2015 Regulations. The client is directed to their duties under Regulation 4 of CDM 2015.
 12. The delivery of this drawing in electronic format shall not be construed to provide any authorisation or right of the recipient or any other person to rely upon, alter or otherwise use the information provided. Any use of this information is at the sole risk and liability of the user and Sustrans assumes no liability for unauthorised use or alteration of the information contained herein.
 13. To ensure the most up to date drawings are being used the project drawing register should be referred to.
 14. For further information on drawing and design revisions, see decision log or contact Sustrans project manager.
 15. This drawing has been produced to be read in colour, for the sheet size specified below. Printing or copying in black and white, or on a different sheet size may lead to misinterpretation of the design.

B	LB Haringey design comments	ZH	GF	GF	31/01/2022
A	RSA & LB Haringey comments	ZH	GF	GF	26/01/2022

sustrans

JOIN THE MOVEMENT

244-254 Cambridge Heath Rd, London E2 9DA
020 7017 2350 www.sustrans.org.uk

Project: **Bruce Grove Design**

Title: **Rusper Road School Street Area B
Extent of School Street
Sheet 1 of 3**

Drawn: Check: Appr: Date: Scale at A3:
ST ZH GF 08/12/2021 1:1000

Status: **CONCEPT**

Drawing No: **BGWC-C-09-00-01** Revision: **B**

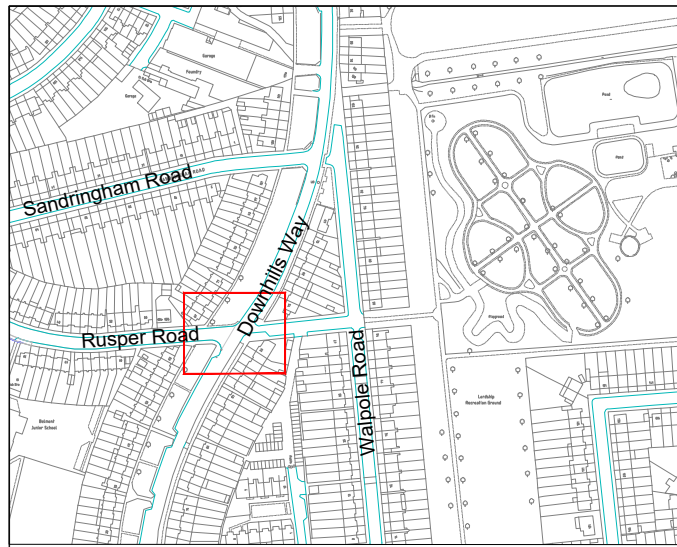

LOCALITY PLAN

Proposed filter with two sets of rectangular planters equipped with reflectors.

Western planters (2x) installed in line with existing building line on Downhills Way 3.2m apart, with bollard in between. Northern planter 0.6m away from northern kerbline, and southern planter 0.6m away from southern kerbline. Install motor vehicles prohibited sign to TSRGD 619 750mm on northern planter and LB Haringey branding sign on southern planter, mounted on planter faces on outer side of the filter facing oncoming traffic (westwards).

Eastern planters (4x) installed in line with existing giveway line on Rusper Road, at junction with Downhills Way, 1.6m apart. Northernmost planter installed 1.6m from existing lighting column on northern footway of Rusper Road. Install motor vehicles prohibited sign to TSRGD 619 750mm on the 1st and 3rd planters from the north, and LB Haringey branding sign on the 2nd and 4th planters, mounted on planter faces on outer side of the filter facing oncoming traffic.

Introduce 'motor vehicles prohibited' sign on proposed sign post (relocated from further west) adjacent to wall and in line with planter to TSRGD Diagram 619, 750mm, west facing.

Remove existing give way sign on existing lighting column, and replace with sign to TSRGD 619, 750mm, east facing.

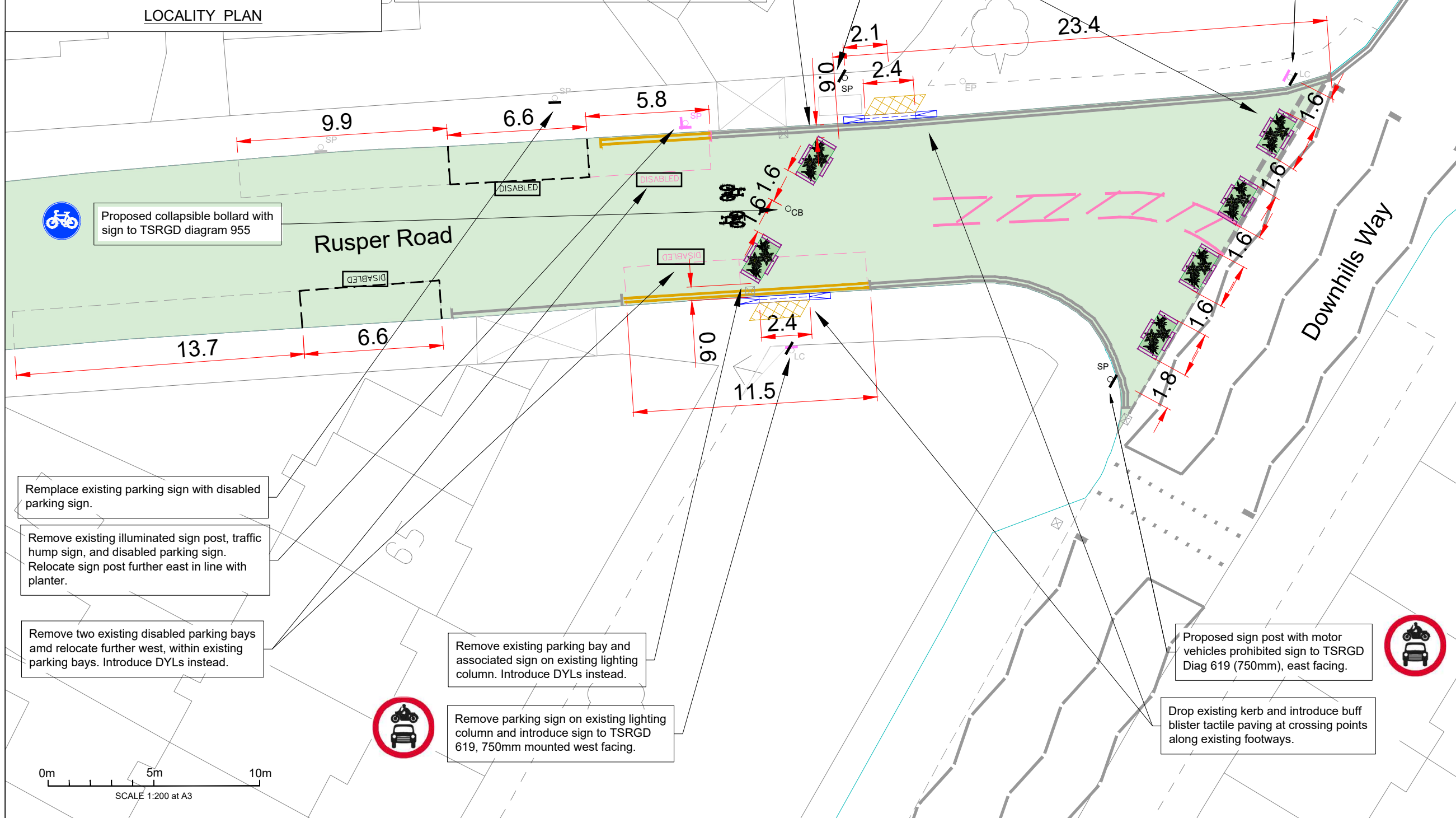

- Key:**
- Existing kerb line (OS base)
 - Existing gully/existing tree
 - Existing lighting column/sign post/bollard
 - Existing crossover
 - Existing line marking
 - Proposed school street
 - Existing sign post with sign/ Proposed sign on existing sign post
 - Remove sign from existing lighting column/ Remove existing sign and post
 - Proposed sign post and sign/Proposed sign on existing lighting column
 - Proposed white line marking
 - Proposed rectangular bolt down kerbs - 0.914m L x 0.15m W x 0.1m H (Rediwell Harlow Kerbs)
 - Proposed rectangular wooden planter 1.8 m L x 1m W x 0.9m H with reflectors
 - Proposed yellow line marking
 - Proposed line marking removal
 - Proposed 300mm dropped kerb
 - Proposed 300mm dropper kerb
 - Proposed buff blister tactile paving
 - Proposed collapsible bollard

- Notes:**
1. Drawing based on OS base, dimensions and street furniture positions to be checked on site and any discrepancies to be reported.
 2. Not all road markings shown.
 3. Proposed cycle markings to TSRGD 1057, 1215mm to be pre-formed thermoplastic.
 4. All planters and bollards to be equipped with reflectors.
 5. Use four bolt down kerb sections around perimeter of each planter to fix planters in place. Maintain gap between each planter and kerbside for drainage purposes. Bolt down kerb sections to be saw cut on site to required lengths.
 6. Low plants to be used in planters to avoid obstructing visibility, except where trees are proposed.
 7. Signs to be mounted with anti-rotational fixings at 2.3m minimum height except where stated otherwise.

- General Notes:**
1. All dimensions in metres, unless otherwise noted.
 2. Do not scale off plan.
 3. Dimensions are to be checked by the contractor prior to commencement of work. Any discrepancy shall be reported immediately to Sustrans.
 4. Drawing based on OS base plan.
 5. Co-ordinates based on OS grid.
 6. Levels based on OS datum (Newlyn).
 7. This drawing is to be read in conjunction with all other relevant drawings and specifications.
 8. All work shall be carried out in accordance with LB Haringey statutory authority and health & safety requirements and regulations.
 9. The position of services is based on information provided by other parties at the time of design and is for guidance only. It is the responsibility of the Client and Contractor to verify the exact position of any services before commencing works on site.
 10. Temporary traffic works must be undertaken in accordance with Chapter 8 parts 1 & 2 of the Traffic Signs Manual, Safety at Street Works and Road Works Code of Practice 2013 and any other relevant H&S legislation.
 11. These drawings have been produced under the CDM 2015 Regulations. The client is directed to their duties under Regulation 4 of CDM 2015.
 12. The delivery of this drawing in electronic format shall not be construed to provide any authorisation or right of the recipient or any other person to rely upon, alter or otherwise use the information provided. Any use of this information is at the sole risk and liability of the user and Sustrans assumes no liability for unauthorised use or alteration of the information contained herein.
 13. To ensure the most up to date drawings are being used the project drawing register should be referred to.
 14. For further information on drawing and design revisions, see decision log or contact Sustrans project manager.
 15. This drawing has been produced to be read in colour, for the sheet size specified below. Printing or copying in black and white, or on a different sheet size may lead to misinterpretation of the design.

B	LB Haringey design comments	ZH	GF	GF	31/01/2022
A	RSA & LB Haringey comments	ZH	GF	GF	26/01/2022

sustrans
 JOIN THE MOVEMENT
 244-254 Cambridge Heath Rd, London E2 9DA
 020 7017 2350 www.sustrans.org.uk

Project: Bruce Grove School Streets

Title: Rusper Road School Street Area B
 Detail Frame 1: Physical Filter
 Page 2 of 3

Drawn:	Check:	Appr:	Date:	Scale at A3:
ST	ZH	GF	08/12/2021	1:200

Status: **CONCEPT**

Drawing No:	Revision:
BGWG-C-09-00-02	B

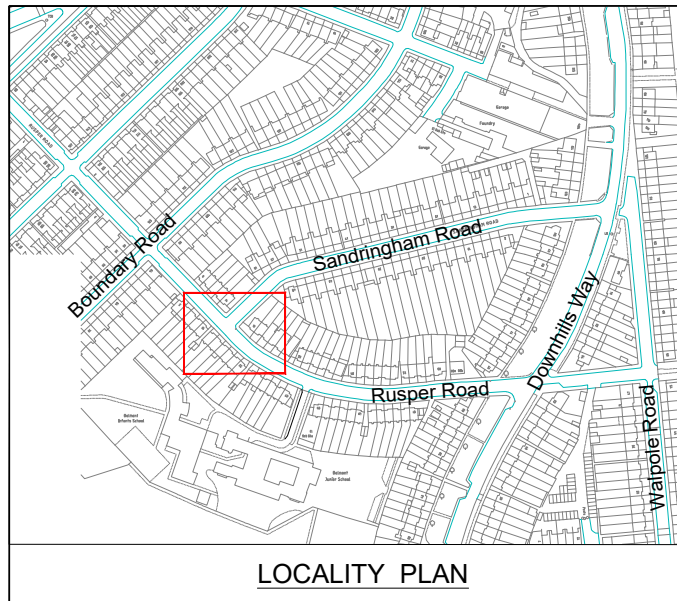

LOCALITY PLAN

DETAIL FRAME 2

Introduce 'no through route' sign to TSRGD 816, with 'except cycles' plate mounted on existing lighting column on southern footway of Rusper Road facing north, tilted slightly towards Sandringham Road.



Introduce new sign post on northern footway of Rusper Road. Mount sign to TSRGD 816, with 'except cycles' plate, and School Street sign to TSRGD Diagram 618.3C (with ID SS20) with camera enforcement sign below, north west facing at 1.8m minimum height.



Extend existing sign post with parking sign and mount School Street sign to TSRGD Diagram 618.3C (with ID SS20) and camera enforcement sign below, north west facing at 1.8m minimum height.

Suspend 4.7m of parking and introduce DYLS instead

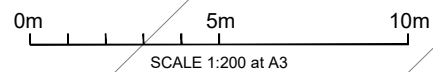

Key:

	Existing kerb line (OS base)
	Existing gully/existing tree
	Existing sign and post
	Existing lighting column/sign post/electricity pole
	Existing crossover
	Existing line marking
	Proposed School Street
	Proposed sign on existing sign post/lighting column
	Proposed sign post and sign
	Proposed white line marking
	Proposed rectangular bolt down kerbs - 0.914m L x 0.15m W x 0.1m H (Redweld Harlow Kerbs)
	Proposed square school street wooden planter 1m L x 1m W x 0.6m H with reflectors
	Proposed yellow line marking
	Proposed line marking removal

- Notes:
- Drawing based on OS base, dimensions and street furniture positions to be checked on site and any discrepancies to be reported.
 - Not all road markings shown.
 - All planters and bollards to be equipped with reflectors.
 - Use four bolt down kerb sections around perimeter of each planter to fix planters in place. Maintain gap between each planter and kerbside for drainage purposes. Bolt down kerb sections to be saw cut on site to required lengths.
 - Low planters to be used in planters to avoid obstructing visibility, except where trees are proposed.
 - Signs to be mounted with anti-rotational fixings at 2.3m minimum height except where stated otherwise.
 - Swept path analysis undertaken indicates 3-axle refuse vehicle (8.74m long) can access all properties.

- General Notes:
- All dimensions in metres, unless otherwise noted.
 - Do not scale off plan.
 - Dimensions are to be checked by the contractor prior to commencement of work. Any discrepancy shall be reported immediately to Sustrans.
 - Drawing based on OS base plan.
 - Co-ordinates based on OS grid.
 - Levels based on OS datum (Newlyn).
 - This drawing is to be read in conjunction with all other relevant drawings and specifications.
 - All work shall be carried out in accordance with LB Haringey statutory authority and health & safety requirements and regulations.
 - The position of services is based on information provided by other parties at the time of design and is for guidance only. It is the responsibility of the Client and Contractor to verify the exact position of any services before commencing works on site.
 - Temporary traffic works must be undertaken in accordance with Chapter 8 parts 1 & 2 of the Traffic Signs Manual, Safety at Street Works and Road Works Code of Practice 2013 and any other relevant H&S legislation.
 - These drawings have been produced under the CDM 2015 Regulations. The client is directed to their duties under Regulation 4 of CDM 2015.
 - The delivery of this drawing in electronic format shall not be construed to provide any authorisation or right of the recipient or any other person to rely upon, alter or otherwise use the information provided. Any use of this information is at the sole risk and liability of the user and Sustrans assumes no liability for unauthorised use or alteration of the information contained herein.
 - To ensure the most up to date drawings are being used the project drawing register should be referred to.
 - For further information on drawing and design revisions, see decision log or contact Sustrans project manager.
 - This drawing has been produced to be read in colour, for the sheet size specified below. Printing or copying in black and white, or on a different sheet size may lead to misinterpretation of the design.

B	LB Haringey design comments	ZH	GF	GF	31/01/2022
A	RSA & LB Haringey comments	ZH	GF	GF	26/01/2022

244-254 Cambridge Heath Rd, London E2 9DA
020 7017 2350 www.sustrans.org.uk

Project: Bruce Grove School Streets

Title: Rusper Road School Street Area B
Detail Frame 2: SS Gateway
Sheet 3 of 3

Drawn:	Check:	Appr:	Date:	Scale at A3:
ST	ZH	GF	08/12/2021	1:200

Status: **CONCEPT**

Drawing No:	Revision:
BGWC-C-09-00-03	B

This product includes mapping data licensed from Ordnance Survey with the permission of HMSO © Crown Copyright LBH 2011. All rights reserved. License number 100019199.

NOTES:

- School Street
- Existing properties eligible for a school street exemption permit

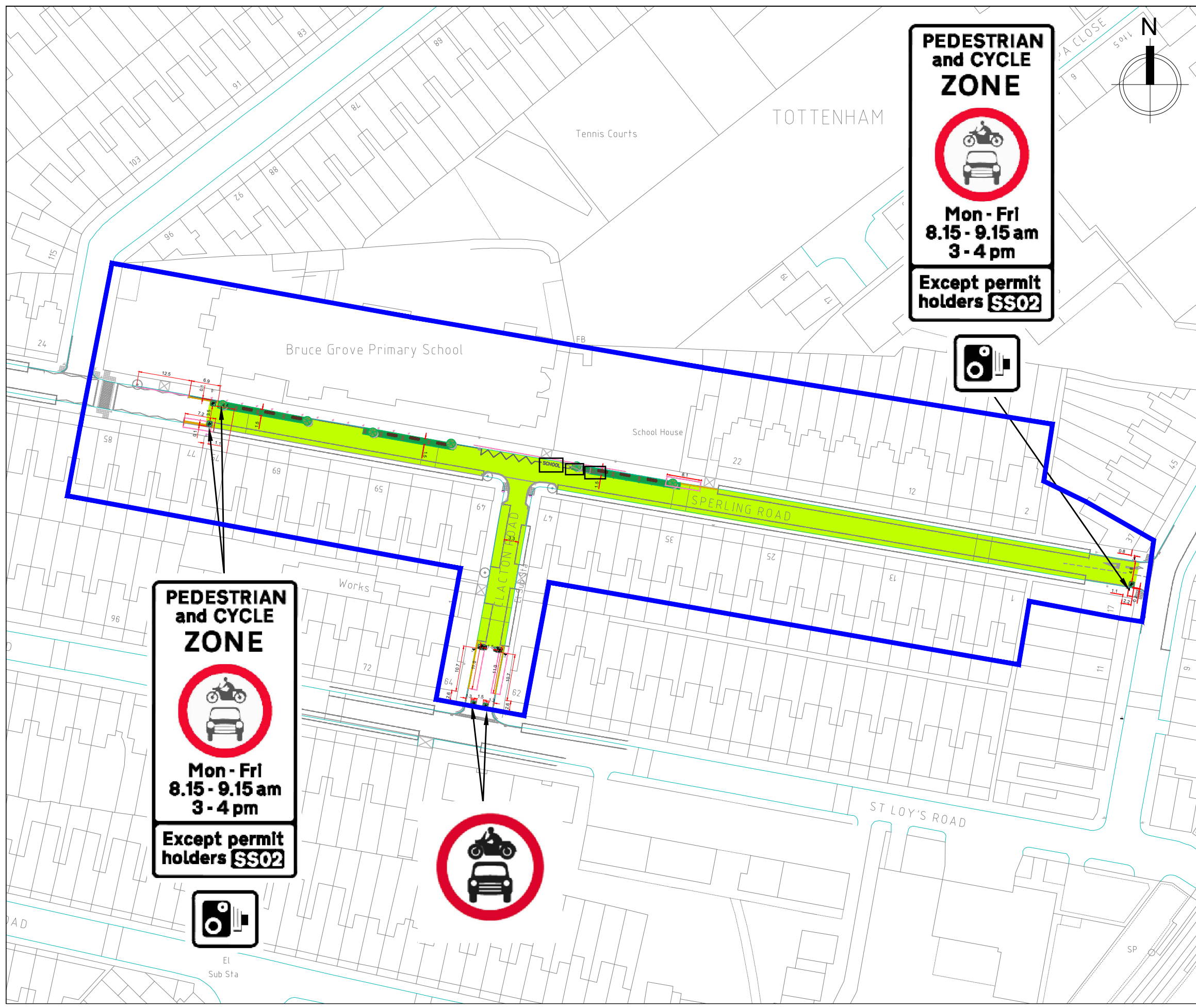

Rev	Description	Checked	Date
Project: SCHOOL STREET			
Title: BRUCE GROVE PRIMARY SPERLING ROAD			
Path: \\lbh.local\hosh-shared\data\EM\StS\High\SV\AMP\Sustainable Transport\TPP Group\00 Traffic and Parking\02 Streets\2021-22\LBH Ann\11 - Design & Drawings\06 - Street School Plans			
Designed:	Drawn:	Checked:	
F.C.	F.C.	S.S.	
Scale:	Date Drawing Created:		
N.T.S.	Jan 2022		
Orig. No:			Rev:
ENVIRONMENT AND NEIGHBOURHOODS			
5th Floor, Alexandra House, 10 Station Road, Wood Green, London N22 7TR Tel: 020 8489 0000 Fax: 020 8489 1251			
Director Place and Sustainability: Lyn Garner			
www.haringey.gov.uk			

**EXPERIMENTAL SCHOOL STREET – BOUNDS GREEN, BRUCE GROVE WEST
GREEN, ST ANN'S**

**The Haringey (Prescribed Routes) (No. **) Experimental Order 2022
The Haringey (Free Parking Places, Loading Places and Waiting, Loading and
Stopping Restrictions) (Amendment No.***) (Experimental) Order 2022
The Haringey (Charged-For Parking Places) (Amendment *) (Experimental) Order 2022**

T05

The experimental Orders designate walk and cycle zones at drop-off and pick-up times in proximity to schools. They also introduce small changes to waiting and parking restrictions to facilitate physical measures associated with the school street restrictions.

The Orders are intended to provide a safer environment for children travelling to and from the school. They are also intended to encourage more physically active journeys and help improve air quality surrounding the school.

The Orders are being introduced as an experimental scheme so that the public's responses to it may be assessed over a trial period, after which the Council will consider whether to make the Orders permanent.

LONDON BOROUGH OF HARINGEY

TRAFFIC MANAGEMENT ORDER

2022 No. 10

The Haringey (Prescribed Routes) (No. 3) Experimental Order 2022

Made: 14th February 2022

Coming into force: 7th March 2022

The Council of the London Borough of Haringey, after consulting the Commissioner of Police of the Metropolis, in exercise of powers conferred by sections 9, 10 and 124 of the Road Traffic Regulation Act 1984(a), and of all other enabling powers, hereby make the following Order:-

Citation and Commencement

1. This Order shall come into force on 7th March 2022 and may be cited as The Haringey (Prescribed Routes) (No. 3) Experimental Order 2022.
2. This Order shall have an effect for a period of not exceeding 18 months from the date specified in Article 1 hereof or until it is made permanent.

Interpretation

3. (1) In this Order, except where the context otherwise requires, the following expressions have the meanings hereby respectively assigned to them:
 - "the Order of 2021" means The Haringey (Moving Traffic Restrictions) Order 2021(c)
 - "map based schedule" means the map attached to and to be read in conjunction with this Order, which depicts the moving restriction which is to be introduced by this Order, and in conjunction with the map schedule legend, which identifies the type of restriction, any permitted exceptions and any specific operating hours.
 - Provided that the Council does not accept responsibility for any inaccuracies contained in the Ordnance Survey data relied upon to create the map based schedule and where a moving restriction is depicted on the map based schedule, that moving restriction will continue to apply irrespective of any subsequent changes that have been made to the underlying Ordnance Survey data.
 - "map schedule legend" means the map schedule legend attached to this Order which, when used in conjunction with the map based schedule, identifies the specific type of moving restrictions imposed by this Order and, where appropriate, certain of their governing provisions;
 - "authorised agent" means the parking services contractor appointed by and acting on behalf of the Council for the purposes of the supervision and enforcement of this Order
 - "Council" means Haringey Council;
 - "disabled person's badge" has the same meaning as in the Local Authorities' Traffic Orders (Exemptions for Disabled Persons) (England) Regulations 2000(c)
 - "enactment" means any enactment, whether public general or local, and includes any order, byelaw, rule, regulation, scheme or other instrument having effect by virtue of an enactment and any reference in this Order to any enactment shall be construed as a reference to that enactment as amended, applied, consolidated, re-enacted by or as having effect by virtue of any subsequent enactment;
 - "goods" means goods of any kind whether animate or inanimate and includes postal packets of any description; and "delivering" and "collecting" in relation to any goods includes checking the goods for the purpose of their delivery or collection;
 - "motor vehicle" has the same meaning as in section 185(1) of the Road Traffic Act 1988(b) and section 136(1) of the Road Traffic Regulation Act 1984;
 - an excursion or tour
 - "permit" means a permit issued under the provisions of Article 8 to this Order;
 - "permit holder" means a person to whom a permit or virtual permit has been issued;
 - "prescribed hours" means between the hours Mon-Fri 8.15-9.15am 3.00-4.00pm, during school term times;

“prescribed zone” means Zone SS02 and lengths of roads specified in Schedule 1 and as indicated in the map based schedule to this Order;

“resident” means a person whose usual place of abode is at a premises listed in column 2 of Schedule 2 to this order;

“telecommunication system” has the same meaning as in the Telecommunications Act 1984(b);

“virtual permit” means a permit issued under the provisions of Article 8 to this Order, which although not in actual form, is nevertheless a permit, by virtue of the motor vehicle’s registration mark appearing on a list of motor vehicles authorised by the Council;

- (2) The prohibitions imposed by this Order are in addition to and not in derogation of any restriction, prohibition or requirement imposed by any other enactment and any exception or exemption from the provisions of this Order is without prejudice to the provisions of any other enactment.

Amendment to the Order of 2021

4. Without prejudice to the validity of anything done or to any liability incurred in respect of any act or omission before the coming into operation of this Order, the Order of 2021 is hereby varied to include the Pedestrian and Cycle Zone as identified in the map based schedule.
5. Schedule 2 of the Order of 2021 is hereby varied by inserting the details in Schedule 2 to this Order.

School Street - Pedestrian and Cycle Zone

6. (a) Save as provided in Article 7 of this Order no person shall cause or permit any motor vehicle to enter the prescribed zone during the prescribed hours in the London Borough of Haringey.

Exemptions

7. Nothing in Article 6 shall apply:
- (a) to a permit holder;
 - (b) to any vehicle leaving the prescribed zone;
 - (c) to any motor vehicle when used for fire brigade, ambulance or police purposes;
 - (d) to any motor vehicle when used by Hatzolah north west ambulance service or any other private ambulance services with written permission of the Council.
 - (e) to anything done with the permission or at the direction of a police constable in uniform;
 - (f) to any motor vehicle when used in the service of a local authority in pursuance of statutory powers or duties provided that in all the circumstances it is reasonably necessary in the exercise of such powers or performance of such duties for the that motor vehicle to enter the prescribed zone;
 - (g) to any royal mail motor vehicle being used in pursuance of statutory functions;
 - (h) to any motor vehicles being used in connection with the maintenance, improvement, reconstruction, cleansing or lighting of the prescribed zone or any road accessible only therefrom, or the laying, erection, alteration or repair of any sewer thereunder or of any main, pipe or apparatus for the supply of gas, water or electricity or of any telecommunications system thereunder or thereon, or the placing, maintenance or removal of any traffic sign thereof provided that in all the circumstances it is reasonably necessary in the exercise of such powers or performance of such duties for the that motor vehicle to enter the prescribed zone;

Application for and issue of permits

8. (1) An application for a permit in respect of a motor vehicle requiring access to the prescribed zone during the restricted hours, may be made to the Council by the following:
- (a) Any residents or businesses within the affected area and listed in column 2 of Schedule 2 to this order, with proof of their vehicle being registered to their address. There should be no more than 2 permits granted per household;
 - (b) Any motor vehicle owned by disabled person who has been issued a valid disabled person’s badge who requires access to a property within the prescribed zone;
 - (c) to any motor vehicle when used by qualified medical practitioners attending to provide critical care to residents within the prescribed zone;
 - (d) to any motor vehicle used in the transport of children and adults with special access needs in connection with and support of the School specified in column 1 of Schedule 2 to this order and with written permission of the Council for that prescribed zone.

- (2) The Council or authorised agent may at any time require an applicant for a permit or a permit holder to produce to an officer of the Council or authorised agent such evidence in respect of an application for a permit made to them as they may reasonably call for to verify any particulars or information given to them or in respect of any permit issued by them as they may reasonably call for to verify that the permit is valid.

Form of permits

9. A permit shall include the following particulars:
 - (a) the registration mark of the motor vehicle in respect of which the permit has been issued;
 - (b) the period during which the permit shall remain valid; and
 - (c) an indication that the permit has been issued by the Council or authorised agent.

Surrender, withdrawal and validity of permits

10. (1) A permit holder may surrender a permit to the Council or authorised agent at any time and shall surrender a permit to the Council or authorised agent on the occurrence of any one of the events set out in paragraph (3) of this Article or in accordance with the provisions of paragraph (4) of this Article.
- (2) The Council or authorised agent may, by notice in writing served on the permit holder by sending the same by recorded delivery service to the permit holder at the address shown by that person on the application for the permit or at any other address believed to be that person's place of abode, withdraw a permit if it appears to the Council or authorised agent that any one of the events set out in paragraph (3)(a),(b) or (e) of this Article has occurred and the permit holder shall surrender the permit to the Council or authorised agent within 48 hours of the receipt of the aforementioned notice.
- (3) The events referred to in the foregoing provisions of this Article are:
 - (a) the permit holder ceasing to be a resident;
 - (b) the permit holder ceasing to be the owner of the motor vehicle in respect of which the permit was issued;
 - (c) the withdrawal of such permit by the Council or authorised agent under the provisions of paragraph (2) of this Article;
 - (d) the issue of a duplicate permit by the Council or authorised agent under the provisions of Article 6
 - (e) the permit ceasing to be valid pursuant to the provisions of paragraph (4) of this Article.
- (4) Without prejudice to the foregoing provisions of this Article, a permit shall cease to be valid at the expiration of the period specified thereon or on the occurrence of any one of the events set out in paragraph (3) of this Article, whichever is the earlier.

Issue of duplicate permits

11. (1) If a permit is accidentally mutilated or defaced or the figures or particulars thereon have become illegible or the colour of the permit has become altered by fading or otherwise, the permit holder shall either surrender it to the Council or authorised agent or apply to the Council or authorised agent for the issue to them of a duplicate permit at an administration fee and the Council or authorised agent, on the receipt of the permit, shall issue a duplicate permit at an administration fee so marked and upon such issue the permit shall become invalid.
- (2) If a permit is lost or destroyed or the motor vehicle changes, the permit holder shall notify the Council or authorised agent of such loss or destruction or changes and may apply to the Council or authorised agent for the issue to them of a duplicate permit at an administration fee and the Council or authorised agent shall issue a duplicate permit and upon such issue the permit shall become invalid.
- (3) The provisions of this Order shall apply to a duplicate permit and an application therefore as if it were a permit or, as the case may be, an application therefore.

Modification or Suspension

12. In pursuance of section 10(2) of the Road Traffic Regulation Act 1984, the Head of Highways and Parking or some other person authorised in that behalf by him or her, may, if it appears to him or her

or that other person essential in the interests of the expeditious, convenient and safe movement of traffic, or of the provision of suitable and adequate on-street parking facilities, or for preserving or improving the amenities of the area through which any road affected by this Order runs, modify or suspend the operation of this Order or any provision of it, save that no modification shall make an addition.

Revocation

13. The Order of 2021 is hereby revoked insofar as it relates to the one way restriction on Clacton Road N17 between its junction with St Loys Road and Sperling Road.

Dated this 14th February 2022

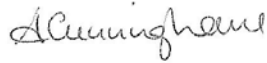

Ann Cunningham
Head of Highways and Parking

Schedule 1

Prescribed Road	Location
Sperling Road N17	From the shared property boundary of No.75/77, east to a point 2.2 metres east of the eastern property boundary of No.17 Moorefield Road.
Clacton Road N17	From its junction with Sperling Road to a point 10.7 metres north of the southern property line of No.64 St Loys Road.

Schedule 2

Pedestrian and cycle zone (1)	Permit eligible properties (2)	Permit identifier (3)
School streets scheme – Bruce Grove Primary School	1-23 Sperling Road (all) 25-87 Sperling Road (odd) Flat A & B, 1 Sperling Road Flat A & B, 5 Sperling Road Left & Right Flat, 12 - 22 Sperling Road (evens) Ground & First Floor Flat, 53 Sperling Road Flat A & B, 57 Sperling Road Ground & First Floor Flat, 59 Sperling Road Studio 1-5, 77 Sperling Road (all) School House, Bruce Grove Primary School Bruce Grove Junior School, Bruce Grove Primary School, Sperling Road 1 Clacton Road Workshop Rear of 1 Clacton Road Chinese Temple, Clacton Road 62 St Loy's Road 64 St Loy's Road Flat A & B, 64 St Loys Road 17 Moorefield Road 37 Moorefield Road Flat A & B, 37 Moorefield Road	SS02

**LONDON BOROUGH OF HARINGEY
TRAFFIC MANAGEMENT ORDER
2022 No. 12**

The Haringey (Free Parking Places, Loading Places and Waiting, Loading and Stopping Restrictions) (Amendment No.5) Experimental Order 2022

Made: 14th February 2022

Coming into force: 7th March 2022

The London Borough of Haringey, after consulting the Commissioner of Police of the Metropolis, in exercise of the powers conferred by sections 9, 10 and 124 of and Part IV of Schedule 9 to the Road Traffic Regulation Act 1984(a) as amended by the Local Government Act 1985 and the Traffic Management Act 2014 and of all other powers thereunto enabling, hereby make the following Order:

Citation and commencement

1. This Order may be cited as the Haringey (Free Parking Places, Loading Places and Waiting, Loading and Stopping Restrictions) (Amendment No.***) Experimental Order 2022* and shall come into force on *****.
2. This Order shall have an effect for a period of not exceeding 18 months from the date specified in Article 1 hereof or until it is made permanent.

Interpretation

3. (1) In this Order:
 - “the Order of 2021” means The Haringey (Free Parking Places, Loading Places and Waiting, Loading and Stopping Restrictions) Order 2021(b).
 - “map based schedule” means the map attached to and to be read in conjunction with this Order, which depicts the parking places and loading places designated by this Order, and the waiting, loading, and stopping restrictions imposed by this Order, and, in conjunction with the map schedule legend, identifies the type of each particular parking place, loading place, waiting restriction, loading restriction or stopping restriction and, if appropriate, certain of its governing provisions:
 - Provided that the Council does not accept responsibility for any inaccuracies contained in the Ordnance Survey data relied upon to create the map based schedule and where a parking place, loading place or waiting, loading or stopping restriction is depicted on the map based schedule, that parking place, loading place or waiting, loading or stopping restriction will continue to apply irrespective of any subsequent changes that have been made to the underlying Ordnance Survey data.
 - “map schedule legend” means the map schedule legend attached to this Order which, when used in conjunction with the map based schedule, identifies the specific type of parking places and loading places designated by this Order, and the waiting, loading and stopping restrictions imposed by this Order and, where appropriate, certain of their governing provisions;
 - “parking place” means an area on a highway designated as a parking place by this Order, being either an ambulance parking place, or a bus parking place, or a diplomatic vehicles parking place, or a disabled persons parking place, or an electric vehicle charging point parking place, or a free short stay parking place, or a free unlimited stay parking place, or a pedal cycle parking place, or a police vehicles parking place, or a solo motor cycle parking place, and in each case being identified as such on the map based schedule, by reference to the map based schedule legend.
- (2) Any reference in this Order to any enactment shall be construed as a reference to that enactment as amended, applied, consolidated, re-enacted by or as having effect by virtue of any subsequent enactment.

- (3) Unless the context otherwise requires, any expression used in this Order which is also used in the Order of 2021 shall have the same meaning as in that Order.

Amendment to the Order of 2021

4. Without prejudice to the validity of anything done or to any liability incurred in respect of any act or omission before the coming into operation of this Order, the Order of 2021 is hereby varied as identified in the map based schedule.

Designation of parking places and loading places

5. (1) Each area on a highway identified in the map based schedule by way of the map schedule legend as a parking place or loading place, as an area marked out and signed for the use therein of specified classes of vehicles following the conditions specified in Article 5 of the Order 2021 in relation to that parking place or loading place, is a designated parking place or loading place, as the case may be.
- (2) Unless otherwise so identified, a parking place or loading place shall be bounded on one side of its length by the edge of the carriageway and be an area marked out to a road marking and depicted by a regulatory sign, either in accordance with the Traffic Signs Regulations and General Directions 2016 or, if applicable, by virtue of any special authorisation given by the Department for Transport.
- (3) The provisions of the Order of 2021 (other than Articles 4 and 15) shall apply to each area designated as a parking place or loading place by this Order as if in those provisions any reference to a parking place or loading place included a reference to each area designated as a parking place or loading place by this Order and as if any reference to the map based schedule to the Order of 2021 included a reference to the map based schedule to this Order.

Waiting and loading restrictions applicable to restricted streets

6. (1) No person shall cause or permit any vehicle to wait during the prescribed hours in any restricted street except, subject to the provisions of the next paragraph, for so long as may be necessary for the purpose of delivering or collecting goods or loading or unloading the vehicle at premises adjacent to the street as identified in the map based schedule.
- (2) No person shall cause or permit any vehicle to wait for the purpose of delivering or collecting goods or loading or unloading the vehicle:
- (a) in any restricted street or part of street during the restricted hours; or
- (b) without prejudice to the provisions of the last foregoing sub-paragraph for a period of more than forty minutes in the same place during the prescribed hours in so far as the same fall between the hours of 11 a.m. and 6.30 p.m. in any restricted street.
- (2) The provisions of the Order of 2021 (other than Articles 16) shall apply to the waiting and loading restrictions introduced by this Order as if in those provisions any reference to the waiting and loading restrictions included a reference to the waiting and loading restrictions by this Order and as if any reference to the map based schedule to the Order of 2021 included a reference to the map based schedule to this Order.

Stopping Restrictions

7. (1) Subject to Article 31 to the Order of 2021 no person shall cause or permit any vehicle:
- (a) to stop or remain at rest on an entrance marking during the no stopping hours identified in the map based schedule.
- (b) other than a taxi to stop or remain at rest on a taxi stopping area during the no stopping hours identified in the map based schedule.
- (c) other than an ambulance to stop or remain at rest on an ambulance stopping area during the no stopping hours identified in the map based schedule.
- (d) other than a police vehicle to stop or remain at rest on a police vehicles stopping area during the no stopping hours identified in the map based schedule.
- (e) to stop or remain at rest on the carriageway identified in the map based schedule.

Placing of traffic signs, etc.

8. The Council shall:
- (1) place and maintain traffic signs indicating the limits of each parking place, each loading place and any waiting, loading and stopping restrictions as identified in the map based schedule;
 - (2) place and maintain in or in the vicinity of each parking place and each loading place, traffic signs indicating that such parking place or loading place as the case may be may be used during the permitted hours for the leaving only of the vehicles specified in Article 5 to the Order of 2021;
 - (3) install a charging post in such position as they think fit in or in the vicinity of each electric vehicle charging point parking place as identified in the map based schedule; and
 - (4) carry out such other work as is reasonably required for the purposes of the satisfactory operation of a parking place, loading place or any waiting, loading and stopping restrictions as identified in the map based schedule, as the case may be.

Modification or Suspension

9. In pursuance of section 10(2) of the Road Traffic Regulation Act 1984, the Head of Highways and Parking or some other person authorised in that behalf by him or her, may, if it appears to him or her or that other person essential in the interests of the expeditious, convenient and safe movement of traffic, or of the provision of suitable and adequate on-street parking facilities, or for preserving or improving the amenities of the area through which any road affected by this Order runs, modify or suspend the operation of this Order or any provision of it, save that no modification shall make an addition.

Dated this 14th February 2022

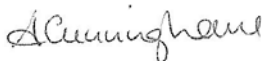

Ann Cunningham
Head of Highways and Parking

EXPLANATORY NOTE

(This is not part of the Order but used to help explain its purpose)

The Haringey (Free Parking Places, Loading Places and Waiting, Loading and Stopping Restrictions) (Amendment No.5) Experimental Order 2022

The general effect of the Order, in conjunction with the Haringey (Charged-For Parking Places) (Amendment No. 4) Experimental Order 2022, is

- a) To extend the double yellow lines on both sides of Clacton Road N17 at its junction with St Loy's Road for 11 metres. This will replace the shared use bays at this location.
- b) To introduce double yellow lines on south side of Sperling Road N17 outside No.77 for 7.2 metres (replacing permit bay) and opposite on the north side of Sperling Road N17 for 6.9 metres (replacing single yellow line).
- c) To remove single yellow line on north side of Sperling Road N17 opposite No.79 to No.83 a distance of 12.5 metres.

**LONDON BOROUGH OF HARINGEY
TRAFFIC MANAGEMENT ORDER
2022 No. 13**

The Haringey (Charged-For Parking Places) (Amendment No. 4) Experimental Order 2022

Made: 14th February 2022

Coming into force: 7th March 2022

The London Borough of Haringey, after consulting the Commissioner of Police of the Metropolis, in exercise of the powers conferred by sections 9, 10 and 124 of and Part IV of Schedule 9 to the Road Traffic Regulation Act 1984(a) as amended by the Local Government Act 1985 and the Traffic Management Act 2014 and of all other powers thereunto enabling, hereby make the following Order:

Citation and commencement

1. This Order may be cited as the Haringey (Charged-For Parking Places) (Amendment No.4) Experimental Order 2022 and shall come into force on 7th March 2022.
2. This Order shall have an effect for a period of not exceeding 18 months from the date specified in Article 1 hereof or until it is made permanent.

Interpretation

1. (1) In this Order:
“the Order of 2021” means The Haringey (Charged-For Parking Places) Order 2021(b).
“map based schedule” means the map attached to and to be read in conjunction with this Order, which depicts the parking places designated by this Order, and in conjunction with the map schedule legend, identifies the type of each particular parking place and, if appropriate, certain of its governing provisions:
Provided that the Council does not accept responsibility for any inaccuracies contained in the Ordnance Survey data relied upon to create the map based schedule and where a parking place is depicted on the map based schedule, that parking place will continue to apply irrespective of any subsequent changes that have been made to the underlying Ordnance Survey data.
“map schedule legend” means the map schedule legend attached to this Order which, when used in conjunction with the map based schedule, identifies the specific type of parking places designated by this Order and, where appropriate, certain of their governing provisions;
“parking place” means an area on a highway designated as a parking place by this Order, being either: a resident permit holders parking place, or a permit holders parking place, or a shared-use resident permit holders and pay parking place, or a shared-use permit holders and pay parking place, or a pay parking place, or a business permit holders parking place, or a shared-use business permit holders and pay parking place, or a street traders permit holders parking place, or a doctors parking place or, a car club parking place, or a disabled permit holders parking place, and in each case being identified as such type in the map based schedule by reference to the map schedule legend.
- (2) Any reference in this Order to any enactment shall be construed as a reference to that enactment as amended, applied, consolidated, re-enacted by or as having effect by virtue of any subsequent enactment.
- (3) Unless the context otherwise requires, any expression used in this Order which is also used in the Order of 2021 shall have the same meaning as in that Order.

Amendment to the Order of 2021

2. Without prejudice to the validity of anything done or to any liability incurred in respect of any act or omission before the coming into operation of this Order, the Order of 2021 is hereby varied as identified in the map based schedule.

Designation of parking places and application of the Order of 2021 thereto

3. (1) Each area on a highway comprising the length of carriageway of the street specified as a parking space in the map based schedule and bounded on one side of that length by the edge of the carriageway and having a minimum width throughout of 1.8 metres is designated as a parking place.
- (2) The provisions of the Order of 2021 (other than Articles 4 and 18) shall apply to each area designated as a parking place by this Order as if in those provisions any reference to a parking place included a reference to each area designated as a parking place by this Order and as if any reference to the map based schedule to the Order of 2021 included a reference to the map based schedule.

Placing of traffic signs, etc.

4. The Council shall:
 - (a) place and maintain traffic signs indicating the limits of the parking places as identified in the map based schedule;
 - (b) place and maintain in or in the vicinity of each parking place as identified in the map based schedule traffic signs indicating that such parking places may be used during the permitted hours for the leaving of vehicles specified in Article 5 to the Order of 2021;
 - (c) place and maintain in or in the vicinity of each shared-use resident permit holders and pay parking place, shared-use permit holders and pay parking place, shared-use business permit holders and pay parking place, or pay parking place, a traffic sign indicating, that such parking place may be used by vehicles making payment of the parking charge by way of the electronic payment system; and the location identification number of such parking place or part thereof as identified in the map based schedule;
 - (d) place and maintain road markings indicating the limits of each parking place (other than in Article 4(2) (a) of the Order of 2021) as identified in the map based schedule;
 - (e) at its discretion, install and maintain in proper working order ticket parking meters in such position as they think fit in or in the vicinity of certain shared-use resident permit holders and pay parking places, shared-use permit holders and pay parking places, shared-use business permit holders and pay parking place, and pay parking places as identified in the map based schedule;
 - (f) carry out such other work as is reasonably required by the Order of 2021 or by this Order for the purposes of the satisfactory operation of the parking place designated by this Order and as identified in the map based schedule.

Modification or Suspension

5. In pursuance of section 10(2) of the Road Traffic Regulation Act 1984, the Head of Highways and Parking or some other person authorised in that behalf by him or her, may, if it appears to him or her or that other person essential in the interests of the expeditious, convenient and safe movement of traffic, or of the provision of suitable and adequate on-street parking facilities, or for preserving or improving the amenities of the area through which any road affected by this Order runs, modify or suspend the operation of this Order or any provision of it, save that no modification shall make an addition.

Dated this 14th February 2022

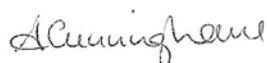

Ann Cunningham
Head of Highways and Parking

EXPLANATORY NOTE

**(This is not part of the Order but used to help explain its purpose)
The Haringey (Charged-For Parking Places) (Amendment No. 4) Experimental Order 2022**

The general effect of the Order, in conjunction with the Haringey (Free Parking Places, Loading Places and Waiting, Loading and Stopping Restrictions) (Amendment No.5) Experimental Order 2022, is to introduce double yellow lines on south side of Sperling Road N17 outside No.77 for 7.2 metres (replacing permit bay) and opposite on the north side of Sperling Road N17 for 6.9 metres (replacing single yellow line).

Public Notice



HARINGEY COUNCIL – PUBLIC NOTICE

EXPERIMENTAL SCHOOL STREET – BRUCE GROVE WEST GREEN

The Haringey (Prescribed Routes) (No. 3) Experimental Order 2022

The Haringey (Prescribed Routes) (No. 4) Experimental Order 2022

The Haringey (Charged-For Parking Places) (Amendment No. 4) Experimental Order 2022

The Haringey (Free Parking Places, Loading Places and Waiting, Loading and Stopping Restrictions) (Amendment No.5) Experimental Order 2022

T05

1. **NOTICE IS HEREBY GIVEN** that the Council of the London Borough of Haringey on 14th February 2022 made the above mentioned Orders under sections 9, 10 and 124 of and Part IV of Schedule 9 to the Road Traffic Regulation Act 1984, as amended.
2. **THE GENERAL EFFECT OF THE EXPERIMENTAL ORDERS** will be to introduce:-

School Street Zone SS02 - Bruce Grove Primary School

- (a) Timed pedestrian and cycle zones in which motor vehicles, except for those issued a permit would be prohibited from entering, Mon-Fri 8.15-9.15am 3.00-4.00pm during school term times and when the appropriate signs are on display:

Sperling Road N17: From the shared property boundary of No.75/77, east to a point 2.2 metres east of the eastern property boundary of No.17 Moorefield Road.
--

Clacton Road N17: From its junction with Sperling Road to a point 10.7 metres north of the southern property line of No.64 St Loys Road.
--

Those eligible for permits include properties and residents of 1-23 Sperling Road (all), 25-87 Sperling Road (odd), Flat A & B, 1 Sperling Road, Flat A & B, 5 Sperling Road, Left & Right Flat, 12 - 22 Sperling Road (evens), Ground & First Floor Flat, 53 Sperling Road, Flat A & B, 57 Sperling Road, Ground & First Floor Flat, 59 Sperling Road, Studio 1-5, 77 Sperling Road (all), , School House, Bruce Grove Primary School, Bruce Grove Junior School, Bruce Grove Primary School, Sperling Road, 1 Clacton Road, Workshop Rear of 1 Clacton Road, Chinese Temple, Clacton Road, 62 St Loy's Road, 64 St Loy's Road, Flat A & B, 64 St Loys Road, 17 Moorefield Road, 37 Moorefield Road, Flat A & B, 37 Moorefield Road Medical practitioners attending those residing in the zone, disabled badge holders who reside outside the zone but require essential access and school buses and vehicles used in the transport of children and adults with special access needs in relation to Bruce Grove Primary School within the zone. All vehicles will be allowed to exit the zone whilst it is in operation.

- (b) Prohibition of Motor Vehicles on Clacton Road N17 from a point 2.6 metres south of the property line of No.64 St Loys Road to a point 13.3 metres north of the southern property line of No.64 St Loys Road.
 - (c) To extend the double yellow lines on both sides of Clacton Road N17 at its junction with St Loy's Road for 11 metres. This will replace the shared use bays at this location.
 - (d) To introduce double yellow lines on south side of Sperling Road N17 outside No.77 for 7.2 metres (replacing permit bay) and opposite on the north side of Sperling Road N17 for 6.9 metres (replacing single yellow line).
 - (e) To remove single yellow line on north side of Sperling Road N17 opposite No.79 to No.83 a distance of 12.5 metres.
 - (f) To revoke the one way restriction on Clacton Road N17, between its junction with St Loys Road and Sperling Road thereby making it two way.
2. **DATE OF OPERATION:** The Orders will come into operation on 7th March 2022 and is due to last for a maximum of 18 months.
 3. The Orders provide that in pursuance of Section 10(2) of the Road Traffic Regulation Act 1984, the delegated authority of the London Borough of Haringey, or some person authorised in that behalf, may if it appears essential in the interests of the expeditious, convenient and safe movement of traffic or for preserving or improving the amenities of the area through which any road affected by the Orders run, modify or suspend the Orders or any provision thereof.
 4. The Council will be considering in due course whether the provisions of the Orders should be continued in force indefinitely by means of permanent Orders made under the relevant sections of the Road Traffic Regulation Act 1984. Any person may object to the making of the permanent Orders for the purpose of such indefinite continuation within a period of six months beginning with the day on which the above mentioned Orders came into force or, if the Orders are varied by other Orders or modified pursuant to section 10(2) of the 1984 Act, beginning with the day on which the latest variation or modification came into force. Any such objection must be made in writing and must state the grounds on which it is made and be sent to Traffic Management Group, River Park House, 1st floor, 225, High Road, Wood Green, N22 8HQ or by email to TMO@haringey.gov.uk.
 5. Copies of the Orders, of the Council's statement of reasons for making the Orders, together with plans showing the location and effect of the Orders may be either: inspected by appointment at the Reception Desk, Alexandra House, 10 Station Road, Wood Green, London N22 7TR; or viewed online at <https://www.haringey.gov.uk/parking-roads-and-travel/roads-and-streets/traffic-management-orders/list-traffic-management-orders-2022#Made> or alternatively on <https://consultation.appyway.com/haringey>; from the date of this Notice until the end of a period of six weeks from the date on the Orders are made, or the Council decides not to make the Orders.
 6. If any person wishes to question the validity of the Orders or of any of its provisions on the grounds they are not within the powers conferred by the Road Traffic Regulation Act 1984, or that any requirement of that Act or of any instrument made under that Act has not been complied with, that person may, within 6 weeks from the date on which the Orders are made, apply for the purpose to the High Court.

Dated: 16th February 2022

Ann Cunningham

Public Notice

Head of Highways and Parking



HARINGEY COUNCIL – PUBLIC NOTICE

EXPERIMENTAL SCHOOL STREET – BOUNDS GREEN, BRUCE GROVE WEST GREEN, ST ANN'S

The Haringey (Prescribed Routes) (No. **) Experimental Order 2022
The Haringey (Free Parking Places, Loading Places and Waiting, Loading and Stopping Restrictions)
(Amendment No.*) (Experimental) Order 2022**
The Haringey (Charged-For Parking Places) (Amendment *) (Experimental) Order 2022

T05

1. **NOTICE IS HEREBY GIVEN** that the Council of the London Borough of Haringey on 14th February 2022 made the above mentioned Orders under sections 9, 10 and 124 of and Part IV of Schedule 9 to the Road Traffic Regulation Act 1984, as amended.
2. **THE GENERAL EFFECT OF THE EXPERIMENTAL ORDERS** will be to introduce:-

School Street Zone SS24 - St Martin of Porres Primary School

- (a) Timed pedestrian and cycle zones in which motor vehicles, except for those issued a permit would be prohibited from entering, Mon-Fri 8.30-9.15am 2.45-3.45pm during school term times, between the prescribed hours below and when the appropriate signs are on display on the following road:

Blake Road N11: From the shared property boundary of No.94/No.96 to a point 2.3 metres south west of north eastern land boundary of No.46 Blake Road.

Those eligible for permits include properties and residents of 35 – 45 Blake Road (odd), 46 – 78 Blake Road (all), 80 – 94 Blake Road (even), Flat A & B, 35 Blake Road, Glencairn Sports Club, Blake Road, Bowling Green, Glencairn Sports Club, Blake Road, qualified medical practitioners attending to provide critical care to residents within the prescribed zone, disabled badge holders who requires access to a property within the prescribed zone and school buses and vehicles used in the transport of children and adults with special access needs in relation to St Martin of Porres Primary School within the zone. All vehicles will be allowed to exit the zone whilst it is in operation.

- (b) To replace the single yellow line (No Waiting Mon-Fri 10am-12Noon) with double yellow lines (No Waiting at Any Time) on south west side of Lynton Gardens N11 at its junction with Blake Road a distance of 11.2 metres.
- (c) To replace the single yellow line (No Waiting Mon-Fri 10am-12Noon) with double yellow lines (No Waiting at Any Time) on south west side of Churston Gardens N11 at its junction with Blake Road a distance of 7.5 metres.
- (d) To replace the single yellow line (No Waiting Mon-Fri 10am-12Noon) with double yellow lines (No Waiting at Any Time) on both sides of Blake Road N11 at its junction with Churston Road a distance of 4.9 metres.
- (e) To introduce double yellow lines (No Waiting at Any Time) on Blake Road N11 outside No.1 Tunnel Gardens N11 a distance of 9 metres.

School Street Zone SS25 - Trinity Primary Academy

- (a) Timed pedestrian and cycle zones in which motor vehicles, except for those issued a permit would be prohibited from entering, Mon-Fri 8:15-9.15am 2.45-3.45pm during school term times and when the appropriate signs are on display on the following road:

Trinity Road N22: From a point 14.1 metres east of the eastern property boundary of No.1 Trinity Road to a point 12.6 metres west of the western property boundary of No.21 Trinity Road (outside Greek Orthodox Cathedral).

Those eligible for permits include properties and residents of 1 – 21 Trinity Road (all), Flat 1 – 6 (all), 3 Trinity Road, Ground & 1st floor flat, 7 Trinity Road, Flat A, 13 Trinity Road, Garden Flat, Ground floor flat, 1st & 2nd floor flat, 14 Trinity Road, Flat 1 – 3 (all), 15 Trinity Road, Flat A & B, 18 Trinity Road, Flat A & B, 19 Trinity Road, Flat A & B, 20 Trinity Road, 1 – 5 Dogan Terrace, Trinity Road, Flat 1 – 8, 287 High Road (all), 287 High Road, 289-295 High Road, St. Marys Greek Cathedral, Greek Orthodox Cathedral, Trinity Road, Trinity Academy, Trinity Primary Academy, Bounds Green Road, Rooftop Communications Station, Civic Centre, High Road, London Borough of Haringey Council Hornsey & Wood Green, Civic Centre, High Road, London, N22 9SA, qualified medical practitioners attending to provide critical care to residents within the prescribed zone, disabled badge holders who requires access to a property within the prescribed zone and school

buses and vehicles used in the transport of children and adults with special access needs in relation to Trinity Primary Academy within the zone. All vehicles will be allowed to exit the zone whilst it is in operation.

School Street Zone SS02 - Bruce Grove Primary School

- (a) Timed pedestrian and cycle zones in which motor vehicles, except for those issued a permit would be prohibited from entering, Mon-Fri 8.15-9.15am 3.00-4.00pm during school term times and when the appropriate signs are on display:

Sperling Road N17: From the shared property boundary of No.75/77, east to a point 2.2 metres east of the eastern property boundary of No.17 Moorefield Road.
--

Clacton Road N17: From its junction with Sperling Road to a point 10.7 metres north of the southern property line of No.64 St Loys Road.
--

Those eligible for permits include properties and residents of 1-23 Sperling Road (all), 25-87 Sperling Road (odd), Flat A & B, 1 Sperling Road, Flat A & B, 5 Sperling Road, Left & Right Flat, 12 - 22 Sperling Road (evens), Ground & First Floor Flat, 53 Sperling Road, Flat A & B, 57 Sperling Road, Ground & First Floor Flat, 59 Sperling Road, Studio 1-5, 77 Sperling Road (all), , School House, Bruce Grove Primary School, Bruce Grove Junior School, Bruce Grove Primary School, Sperling Road, 1 Clacton Road, Workshop Rear of 1 Clacton Road, Chinese Temple, Clacton Road, 62 St Loy's Road, 64 St Loy's Road, Flat A & B, 64 St Loys Road, 17 Moorefield Road, 37 Moorefield Road, Flat A & B, 37 Moorefield Road, qualified medical practitioners attending to provide critical care to residents within the prescribed zone, disabled badge holders who requires access to a property within the prescribed zone and school buses and vehicles used in the transport of children and adults with special access needs in relation to Bruce Grove Primary School within the zone. All vehicles will be allowed to exit the zone whilst it is in operation.

- (b) Prohibition of Motor Vehicles on Clacton Road N17 from a point 2.6 metres south of the property line of No.64 St Loys Road to a point 13.3 metres north of the southern property line of No.64 St Loys Road.
- (c) To extend the double yellow lines on both sides of Clacton Road N17 at its junction with St Loy's Road for 11 metres. This will replace the shared use bays at this location.
- (d) To introduce double yellow lines on south side of Sperling Road N17 outside No.77 for 7.2 metres (replacing permit bay) and opposite on the north side of Sperling Road N17 for 6.9 metres (replacing single yellow line).
- (e) To remove single yellow line on north side of Sperling Road N17 opposite No.79 to No.83 a distance of 12.5 metres.

School Street Zone SS20 - Belmont Infant & Junior School

- (a) Timed pedestrian and cycle zones in which motor vehicles, except for those issued a permit would be prohibited from entering, Mon-Fri 8.30-9.30am 3.00-4.00pm during school term times and when the appropriate signs are on display:

Rusper Road N22: From the shared property boundary of No.17/19 Rusper Road to a point 23.4 metres west of Downhills Way.
--

Those eligible for permits include properties and residents of Flat 1-6, 65 Downhills Way (all), 65 Downhills Way, 67 Downhills Way, 16-61 Rusper Road (all), 60A Rusper Road, 60B Rusper Road, qualified medical practitioners attending to provide critical care to residents within the prescribed zone, disabled badge holders who requires access to a property within the prescribed zone and school buses and vehicles used in the transport of children and adults with special access needs in relation to Belmont Infant & Junior School within the zone. All vehicles will be allowed to exit the zone whilst it is in operation.

- (b) Prohibition of Motor Vehicles on Rusper Road N22 at its junction with Downhills Way, west for 23.4 metres.
- (c) To replace Resident Bay & Disabled Bay with Double Yellow Lines (No Waiting at Any Time) on south side Rusper Road N22 located east of the land boundary of No.65 Downhills Way for 11.5 metres in total.
- (d) To replace Resident Bay with Double Yellow Lines (No Waiting at Any Time) on south west side of Rusper Road N22 located outside No.19 for 4.7 metres.
- (e) To relocate the Disabled Parking Bay on the south side of Rusper Road N22 outside No.65, the bay will be moved west by 5.5 metres and will replace a section of Resident Permit Bay. Double yellow lines will be introduced in its original place as detailed in point (m). The Disabled Parking Bay will be 6.6 metres in length.
- (f) To relocate the Disabled Parking Bay on the north side of Rusper Road N22 from outside No.67, to outside No.60B which will replace a section of Resident Permit Bay. Double yellow lines will be

introduced in its original place.

School Street Zone SS14 - St Ann's CE Primary School

- (a) Timed pedestrian and cycle zones in which motor vehicles, except for those issued a permit would be prohibited from entering, Mon-Fri 8.30-9.30am 3.00-4.00pm during school term times and when the appropriate signs are on display:

Avenue Road N15: From a point 6.7 metres north of its junction with St Ann's Road, to the southern kerb line of Newsam Avenue.
--

Those eligible for permits include properties and residents of St. Anns Church, St Anns Church Hall, 2 Avenue Road, Flat A-F, 11 Avenue Road (all), Ground Floor Flat, Flat A & B 13 Avenue Road, Flat 1-5, 18 Avenue Road (all), Flat A-F, 19 Avenue Road (all), Flat 1-5, 20 Avenue Road (all), Flat 1-6, 21 Avenue Road (all), Flat 1-8, 22 Avenue Road (all), Ground Floor Flat A, Flat B, 23 Avenue Road, Flat 1-6 Windsor Court, 24 Avenue Road, Flat A, 28 Avenue Road, Vehicle Repair Workshop Adjoining 28 Avenue Road, Stroud Green Windows, 28 Avenue Road, Shop, 28 Avenue Road, Flat A & B, Mimosa, 29 Avenue Road, 1-25 Mimosa, 29 Avenue Road (all), Flat A, B, C 33 Avenue Road, Flat A & B 36 Avenue Road, Store At Rear, 38 Avenue Road, Flat 1-4 38 Avenue Road (all), Ground Floor Flat A, Flat B, 40 Avenue Road, Flat 1-4, 45 Avenue Road, Ground Floor Flat, 1st Floor, Flat 49 Avenue Road, Flat A & B, 56 Avenue Road, Flat A, 62 Avenue Road, Flat A, 64 Avenue Road, Chestnuts Pre School, Fowler Newsam Hall, Avenue Road, 1, 1A, 2A, 3, 5 Avenue Road, 12-17 Avenue Road (all), 19, 21, 22, 25, 30 Avenue Road, 32-64 Avenue Road (all), qualified medical practitioners attending to provide critical care to residents within the prescribed zone, disabled badge holders who requires access to a property within the prescribed zone and school buses and vehicles used in the transport of children and adults with special access needs in relation to St Ann's CE Primary School within the zone. All vehicles will be allowed to exit the zone whilst it is in operation.

School Street Zone SS28 - Seven Sisters Primary School

- (a) Timed pedestrian and cycle zones in which motor vehicles, except for those issued a permit would be prohibited from entering, Mon-Fri 8.30-9.30am 3.00-4.00pm during school term times and when the appropriate signs are on display:

South Grove N15: From a point 5.7 metres north of northern kerb line of Oulton Road to Newsam Avenue.
Newsam Avenue N15: From South Grove to Avenue Road.

Those eligible for permits include properties and residents of The School House, School House, 2A South Grove, Seven Sisters Primary School, 9 South Grove, 17-21 South Grove (odd), Workshop A-D, 17 South Grove (all), Flat A-D 19-21 South Grove (all), 23A South Grove, 23 South Grove, 27- 39 South Grove (odd), 2-8 Newsam Avenue (even), 168 – 172 Roslyn Road (even), 46 Oulton Road, 64 Avenue Road, 66 Avenue Road, qualified medical practitioners attending to provide critical care to residents within the prescribed zone, disabled badge holders who requires access to a property within the prescribed zone and school buses and vehicles used in the transport of children and adults with special access needs in relation to Seven Sisters Primary School within the zone. All vehicles will be allowed to exit the zone whilst it is in operation.

- (b) To replace Permit bay with Double Yellow Lines (No Waiting at Any Time) on east side of South Grove N15 adjacent to No.46 Oulton Road N15 for 3.5 metres.

School Street Zone SS19 - West Green Primary School

- (a) Timed pedestrian and cycle zones in which motor vehicles, except for those issued a permit would be prohibited from entering, Mon-Fri 8.30-9.30am 3.00-4.00pm during school term times and when the appropriate signs are on display:

Woodlands Park Road N15: From its junction with West Green Road, south to the northern kerb line of the access road to Rowleys Yard.
--

Those eligible for permits include properties and residents of 1-31 Culross Close (all), 46-71 Culross Close (all), West Green Primary School, Woodlands Park Road, School House, West Green Primary School, Woodlands Park Road, Store Rear Of 1a - 5a, Woodlands Park Road, 2A Woodlands Park Road, Woodlands Estates, 3A Woodlands Park Road, First Floor Flat, 4A Woodlands Park Road, Shop, 4A Woodlands Park Road, 4A Woodlands Park Road, 5A Woodlands Park Road, qualified medical practitioners attending to provide critical care to residents within the prescribed zone, disabled badge holders who requires access to a property within the prescribed zone and school buses and vehicles used in the transport of children and adults with special access needs in relation to West Green Primary School within the zone. All vehicles will be allowed to exit the zone whilst it is in operation.

- (b) To replace existing single yellow line operation Mon-Fri 8am-6.30pm with Double Yellow lines (No Waiting at Any Time) on Woodlands Park Road N15: 1) East side across the access road to Rowleys Yard a distance of 10.5 metres. 2) West across the access south of No.5a a distance of 8.2 metres. This will reduce the Resident Permit Bay by 1.3 metres on the west side and 2 metres on the east side.
3. **DATE OF OPERATION:** The Orders will come into operation on 7th March 2022 and is due to last for a maximum of 18 months.
4. The Orders provide that in pursuance of Section 10(2) of the Road Traffic Regulation Act 1984, the delegated authority of the London Borough of Haringey, or some person authorised in that behalf, may if it appears essential in the interests of the expeditious, convenient and safe movement of traffic or for preserving or improving the amenities of the area through which any road affected by the Orders run, modify or suspend the Orders or any provision thereof.
5. The Council will be considering in due course whether the provisions of the Orders should be continued in force indefinitely by means of permanent Orders made under the relevant sections of the Road Traffic Regulation Act 1984. Any person may object to the making of the permanent Orders for the purpose of such indefinite continuation within a period of six months beginning with the day on which the above mentioned Orders came into force or, if the Orders are varied by other Orders or modified pursuant to section 10(2) of the 1984 Act, beginning with the day on which the latest variation or modification came into force. Any such objection must be made in writing and must state the grounds on which it is made and be sent to Traffic Management Group, River Park House, 1st floor, 225, High Road, Wood Green, N22 8HQ or by email to TMO@haringey.gov.uk.
6. Copies of the Orders, of the Council's statement of reasons for making the Orders, together with plans showing the location and effect of the Orders may be either: inspected by appointment at the Reception Desk, Alexandra House, 10 Station Road, Wood Green, London N22 7TR; or viewed online at <https://www.haringey.gov.uk/parking-roads-and-travel/roads-and-streets/traffic-management-orders/list-traffic-management-orders-2022#Made> or alternatively on <https://consultation.appyway.com/haringey>; from the date of this Notice until the end of a period of six weeks from the date on the Orders are made, or the Council decides not to make the Orders.
7. If any person wishes to question the validity of the Orders or of any of its provisions on the grounds they are not within the powers conferred by the Road Traffic Regulation Act 1984, or that any requirement of that Act or of any instrument made under that Act has not been complied with, that person may, within 6 weeks from the date on which the Orders are made, apply for the purpose to the High Court.

Dated: 16th February 2022

Ann Cunningham
Head of Highways and Parking

HARINGEY COUNCIL – PUBLIC NOTICE

**EXPERIMENTAL MODIFICATION TO BRUCE GROVE PRIMARY SCHOOL
STREET – BRUCE GROVE WEST GREEN**

**The Haringey (Prescribed Routes) (No. 3) (Modification No.1) Experimental
Order 2022**

T05

Statement of Reasons

The experimental School Street which was introduced on Sperling Road on the 7th March 2022 needs to be modified to facilitate the proposed Low Traffic Neighbourhood (LTN) which introduces various traffic filters throughout the Bruce Grove West Green area. The LTN will commence on the 1st November and is being proposed to promote walking and cycling in the borough and improve air quality.

Public Notice



HARINGEY COUNCIL – PUBLIC NOTICE

EXPERIMENTAL MODIFICATION TO BRUCE GROVE PRIMARY SCHOOL STREET – BRUCE GROVE WEST GREEN

The Haringey (Prescribed Routes) (No. 3) (Modification No.1) Experimental Order 2022

T05

- NOTICE IS HEREBY GIVEN** that the Council of the London Borough of Haringey on 14th October 2022 made the above mentioned Orders under sections 9, 10 and 124 of and Part IV of Schedule 9 to the Road Traffic Regulation Act 1984, as amended.
- THE GENERAL EFFECT OF THE EXPERIMENTAL MODIFICATION ORDER** will be to modify The Haringey (Prescribed Routes) (No. 3) Experimental Order 2022 to amend the description of the location of the School Street Zone SS02 - Bruce Grove Primary School on Sperling Road N17 to

Sperling Road N17: At the shared property boundary of No.75/77.

- DATE OF OPERATION:** The Orders will come into operation on 1st November 2022 and is due to last for a maximum of 18 months.
- The Orders provide that in pursuance of Section 10(2) of the Road Traffic Regulation Act 1984, the delegated authority of the London Borough of Haringey, or some person authorised in that behalf, may if it appears essential in the interests of the expeditious, convenient and safe movement of traffic or for preserving or improving the amenities of the area through which any road affected by the Orders run, modify or suspend the Orders or any provision thereof.
- The Council will be considering in due course whether the provisions of the Orders should be continued in force indefinitely by means of permanent Orders made under the relevant sections of the Road Traffic Regulation Act 1984. Any person may object to the making of the permanent Orders for the purpose of such indefinite continuation within a period of six months beginning with the day on which the above mentioned Orders came into force or, if the Orders are varied by other Orders or modified pursuant to section 10(2) of the 1984 Act, beginning with the day on which the latest variation or modification came into force. Any such objection must be made in writing and must state the grounds on which it is made and be sent to Traffic Management Group, River Park House, 1st floor, 225, High Road, Wood Green, N22 8HQ or by email to TMO@haringey.gov.uk.
- Copies of the Orders, of the Council's statement of reasons for making the Orders, together with plans showing the location and effect of the Orders may be either: inspected by appointment at the Reception Desk, Alexandra House, 10 Station Road, Wood Green, London N22 7TR; or viewed online at <https://www.haringey.gov.uk/parking-roads-and-travel/roads-and-streets/traffic-management-orders/list-traffic-management-orders-2022#Made> or alternatively on <https://consultation.appyway.com/haringey>; from the date of this Notice until the end of a period of six weeks from the date on the Orders are made, or the Council decides not to make the Orders.
- If any person wishes to question the validity of the Orders or of any of its provisions on the grounds they are not within the powers conferred by the Road Traffic Regulation Act 1984, or that any requirement of that Act or of any instrument made under that Act has not been complied with, that person may, within 6 weeks from the date on which the Orders are made, apply for the purpose to the High Court.

Dated: 19th October 2022

Ann Cunningham
Head of Highways and Parking

LONDON BOROUGH OF HARINGEY

TRAFFIC MANAGEMENT ORDER

2022 No. 157

The Haringey (Prescribed Routes) (No. 3) (Modification No.1) Experimental Order 2022

Made: 14th October 2022

Coming into force: 1st November 2022

The Council of the London Borough of Haringey, after consulting the Commissioner of Police of the Metropolis, in exercise of powers conferred by sections 9, 10 and 124 of the Road Traffic Regulation Act 1984(a), and of all other enabling powers, hereby make the following Order:-

Citation and Commencement

1. This Order shall come into force on 1st November 2022 and may be cited as The Haringey (Prescribed Routes) (No. 3) (Modification No.1) Experimental Order 2022.
2. This Order shall have an effect for a period of not exceeding 18 months from the date specified in Article 1 hereof or until it is made permanent.

Interpretation

3. (1) In this Order, except where the context otherwise requires, the following expressions have the meanings hereby respectively assigned to them:
“the Order of 2021” means The Haringey (Moving Traffic Restrictions) Order 2021(b)
“the Order of 2022” means The Haringey (Prescribed Routes) (No. 3) Experimental Order 2022 (c)
- (2) The prohibitions imposed by this Order are in addition to and not in derogation of any restriction, prohibition or requirement imposed by any other enactment and any exception or exemption from the provisions of this Order is without prejudice to the provisions of any other enactment.

Amendment to the Order of 2021

4. Without prejudice to the validity of anything done or to any liability incurred in respect of any act or omission before the coming into operation of this Order, the Order of 2022 is hereby modified to substitute the description of Sperling Road in Schedule 1 to that detailed in Schedule 1 to this Order.
5. Schedule 2 of the Order of 2021 is hereby varied by inserting the details in Schedule 1 to this Order.

Modification or Suspension

6. In pursuance of section 10(2) of the Road Traffic Regulation Act 1984, the Head of Highways and Parking or some other person authorised in that behalf by him or her, may, if it appears to him or her or that other person essential in the interests of the expeditious, convenient and safe movement of traffic, or of the provision of suitable and adequate on-street parking facilities, or for preserving or improving the amenities of the area through which any road affected by this Order runs, modify or suspend the operation of this Order or any provision of it, save that no modification shall make an addition.

Dated this 14th October 2022

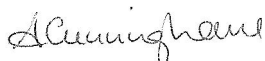

Ann Cunningham
Head of Highways and Parking

Schedule 1

Prescribed Road	Location
Sperling Road N17	At the shared property boundary of No.75/77.